

Compact Type ZP3 Series

RoHS

Model Selection

ø1.5, ø2, ø3.5, ø4, ø6, ø8, ø10, ø13, ø16

Flat Type, Flat Type with Groove, Bellows Type, Bellows Type with Ribs

Overall length shortened For the flat type (Pad diameter: ø2)

ZP3 Compact

Flat Type

Flat Type with Groove

Bellows Type

Bellows Type with Ribs

Construction

Mounting Bracket Assembly

Precautions

Pad unit

Max. 9 mm shorter

With adapter

Max. 11 mm shorter

Actual size

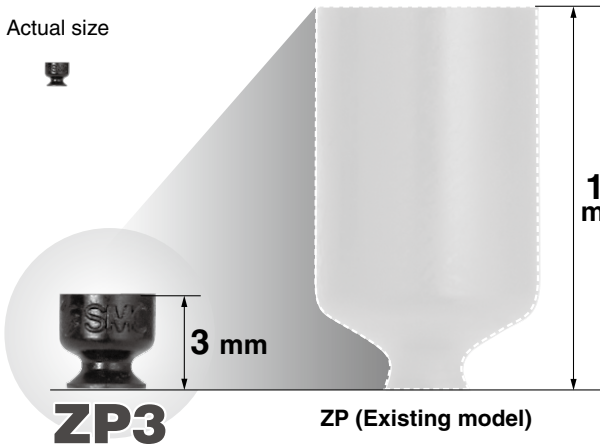

ZP3

ZP (Existing model)

Actual size

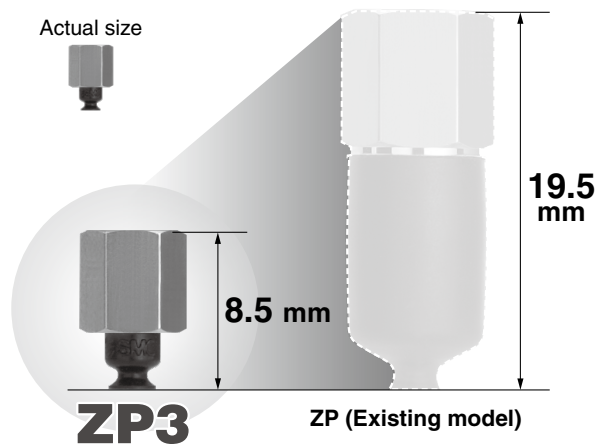

ZP3

ZP (Existing model)

Space saving ø2 piping reduces working space!

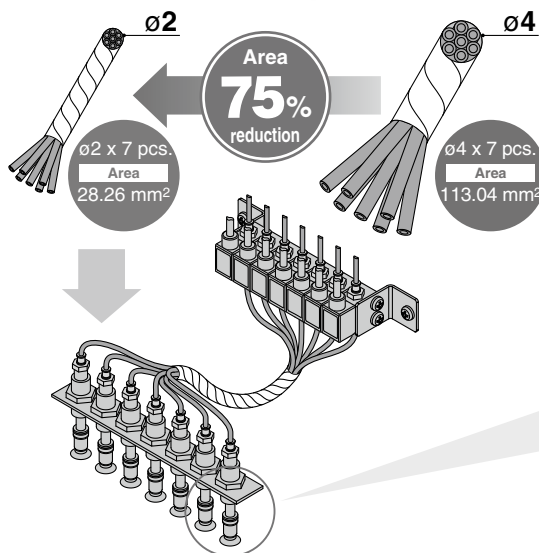

Vertical

- Male thread
- Female thread
- Barb fitting (Applicable tubing: ø2)
- One-touch fitting (Applicable tubing: ø2)

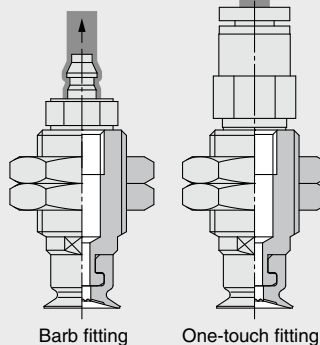

Barb fitting

One-touch fitting

Lateral

- Female thread
- Barb fitting (Applicable tubing: ø2)
- One-touch fitting (Applicable tubing: ø2)

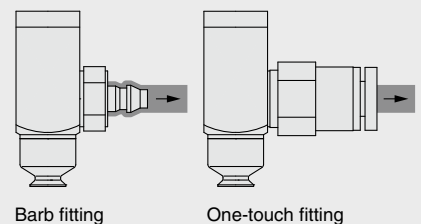

Barb fitting

One-touch fitting

CONTENTS

Compact Type ZP3 Series

Features.....	p. 133
Variations.....	p. 134
Specifications.....	p. 135
Flat Type	
· How to Order.....	p. 136
· Dimensions/Models.....	p. 137
Flat Type with Groove	
· How to Order.....	p. 142
· Dimensions/Models.....	p. 143

Bellows Type

· How to Order.....	p. 148
· Dimensions/Models.....	p. 149

Bellows Type with Ribs

· How to Order.....	p. 154
· Dimensions/Models.....	p. 155
Construction.....	p. 160
Mounting Bracket Assembly.....	p. 162
Specific Product Precautions.....	p. 165



Improved functions

Improved removability

Adsorption surface is shot-blasted

Micro-dents and bumps on the surface facilitate easy removal.

With groove

Less contact surface with the workpiece makes it easy to remove.



Construction to prevent the pad from coming off

The new shape of the part which connects with the adapter prevents the pad from coming off.



Pad diameter from $\phi 1.5$

Easier identification

SMC logo mark



Fixing boss which allows for easy mounting and repeatability

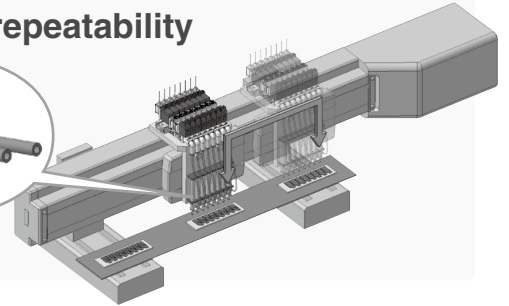
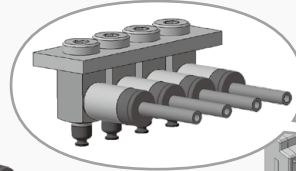
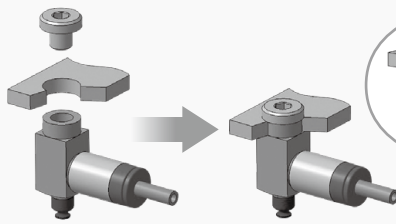

Compact buffer body

Overall length shortened

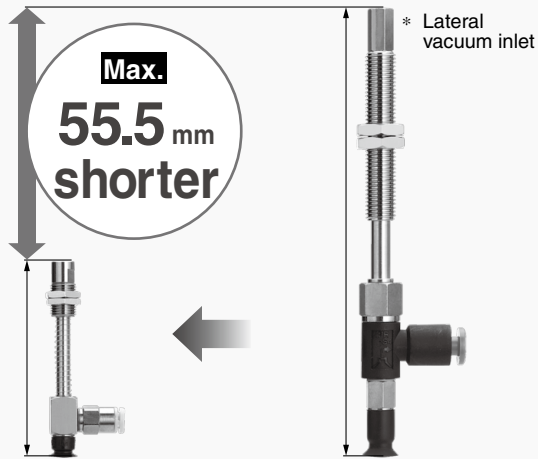

ZP3

ZP

Pad diameter $\phi 8$, Flat type, With One-touch fitting

ZP3

Stroke	Overall length [mm]
3	40
6	46
10	56
15	59
20	66.5
25	—

ZP

Stroke	Overall length [mm]
3	—
6	78.5
10	109.5
15	114.5
20	—
25	124.5

Short stroke type: 3 mm available

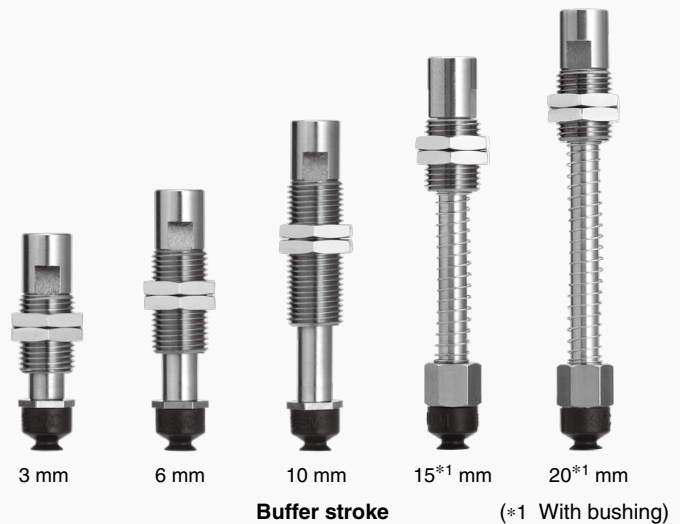

Buffer stroke

(*1 With bushing)

Pad diameter	Buffer specifications	Stroke [mm]				
		3	6	10	15	20
$\phi 1.5, \phi 2, \phi 3.5$	Rotating, Non-rotating	●	●	—	—	—
	Rotating	●	●	●	—	—
$\phi 4, \phi 6, \phi 8, \phi 10, \phi 13, \phi 16$	Rotating, With bushing	—	—	—	●	●
	Non-rotating	●	●	●	●	●

Wide selection of piping

Male thread

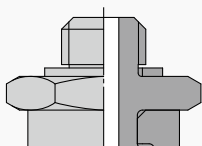

Female thread

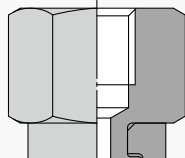



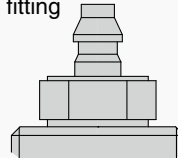

For $\phi 2$ piping!

Barb fitting

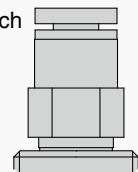

One-touch fitting

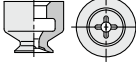
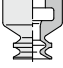
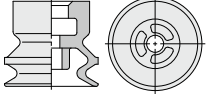

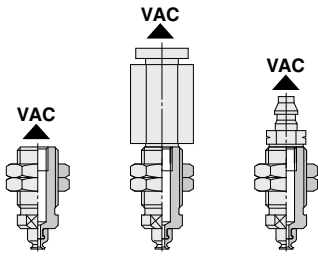
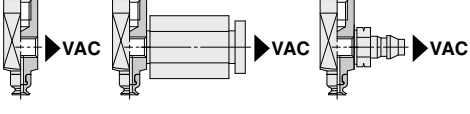
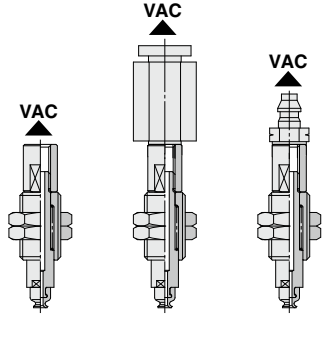
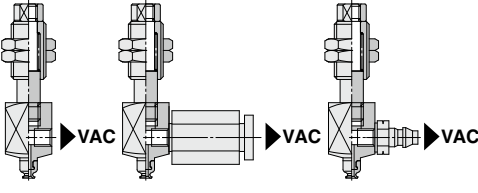
		Vacuum inlet direction									
		Flat type	Flat type with groove	Bellows type	Bellows type with ribs						
Vacuum inlet direction	Single unit					p. 137	p. 143	p. 149	p. 155		
	Vertical	ZP3-T With adapter					p. 137	p. 143	p. 149	p. 155	
		ZP3-T With adapter					p. 138	p. 144	p. 150	p. 156	
		Lateral	ZP3-Y With adapter					p. 139	p. 145	p. 151	p. 157
			ZP3-T With buffer					p. 140	p. 146	p. 152	p. 158
	Lateral	ZP3-Y With buffer					p. 141	p. 147	p. 153	p. 159	

Model Selection

ZP3 Compact

Flat Type

Flat Type with Groove

Bellows Type

Bellows Type with Ribs

Construction

Mounting Bracket Assembly

Precautions

Compact Type *ZP3 Series* Specifications

Pad Material

Material	NBR (Nitrile rubber)	Silicone rubber*1	Urethane rubber	FKM (Fluoro rubber)	Conductive NBR (Nitrile rubber)	Conductive silicone rubber
Color of rubber	Black	White	Brown	Black		
Rubber hardness HS ($\pm 5^\circ$)	A60/S					
Identification (Dot)	—	—	—	· 1 green dot	· 1 silver dot	· 1 pink dot

*1 Compliant with the FDA (USA Food and Drug Administration) regulation 21CFR§177.2600 for "Rubber articles intended for repeated use"

Adapter Specifications

Vacuum Inlet Direction **Vertical** T Type/ZP3-T

Connection		Male thread					Female thread		
Pad diameter		$\phi 1.5$ to $\phi 3.5$		$\phi 4$ to $\phi 8$		$\phi 10$ to $\phi 16$			
Connection thread		M3 x 0.5	M6 x 0.75	M5 x 0.8	M10 x 1	M5 x 0.8	M12 x 1	M3 x 0.5	M5 x 0.8
Vacuum inlet	Female thread	Use the connection thread.	M3 x 0.5	Use the connection thread.	M5 x 0.8	Use the connection thread.	M5 x 0.8	Use the connection thread.	Use the connection thread.
	One-touch fitting		$\phi 2, \phi 4$		$\phi 2, \phi 4$		$\phi 2, \phi 4, \phi 6$		
	Barb fitting*1		$\phi 2, \phi 4$		$\phi 2, \phi 4$		$\phi 2, \phi 4, \phi 6$		

*1 $\phi 2$ polyurethane tubing, $\phi 4, \phi 6$ soft tubing

Vacuum Inlet Direction **Lateral** Y Type/ZP3-Y

Connection		Female thread		
Pad diameter		$\phi 1.5$ to $\phi 3.5$	$\phi 4$ to $\phi 8$	$\phi 10$ to $\phi 16$
Connection thread		M3 x 0.5	M5 x 0.8	M5 x 0.8
Vacuum inlet	Female thread	M3 x 0.5	M5 x 0.8	M5 x 0.8
	One-touch fitting	$\phi 2, \phi 4$	$\phi 2, \phi 4$	$\phi 2, \phi 4, \phi 6$
	Barb fitting*1	$\phi 2, \phi 4$	$\phi 2, \phi 4$	$\phi 2, \phi 4, \phi 6$

*1 $\phi 2$ polyurethane tubing, $\phi 4, \phi 6$ soft tubing

Buffer Specifications

Pad diameter		$\phi 1.5$ to $\phi 3.5$		$\phi 4$ to $\phi 16$		
Non-rotating specification		J: Rotating	K: Non-rotating	J: Rotating	JB: Rotating, With bushing	K: Non-rotating
Stroke [mm]		3, 6		3, 6, 10	15, 20	3, 6, 10, 15, 20
Connection thread		M6 x 0.75	M8 x 0.75	M8 x 0.75		
Spring reactive force [N]	At 0 stroke	0.2		0.2		
	At full stroke	0.4	0.5	0.5		



Compact Type

Flat Type

ZP3 Series

Pad diameter: $\varnothing 1.5$, $\varnothing 2$, $\varnothing 3.5$



Model Selection

ZP3 Compact

Flat Type

Flat Type with Groove

Bellows Type

Bellows Type with Ribs

Construction

Mounting Bracket Assembly

Precautions

How to Order

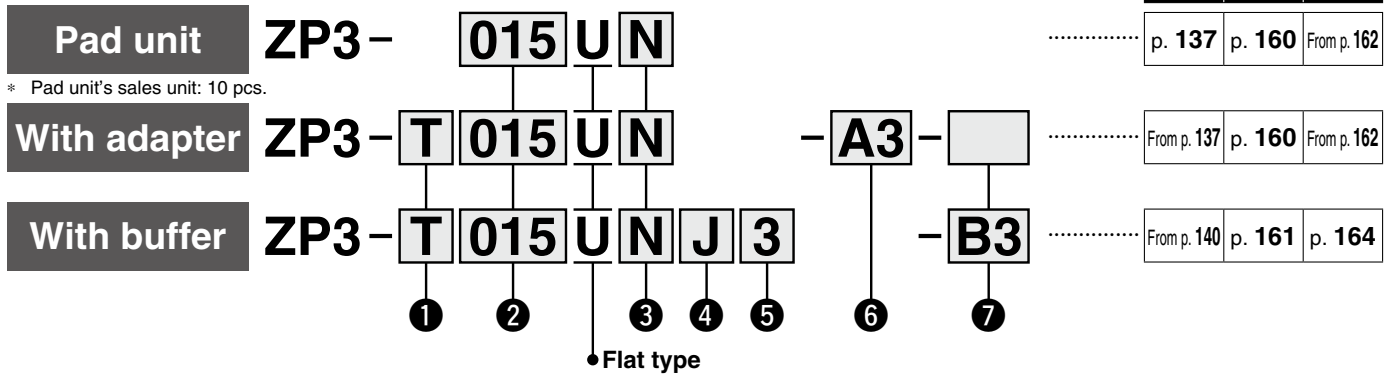

① Vacuum inlet direction

Nil	Pad unit
T	Vertical
Y	Lateral

② Pad diameter

015	$\varnothing 1.5$
02	$\varnothing 2$
035	$\varnothing 3.5$

③ Material

N	NBR
S	Silicone rubber*1
U	Urethane rubber
F	FKM
GN	Conductive NBR
GS	Conductive silicone rubber

*1 Compliant with the FDA (USA Food and Drug Administration) regulation 21CFR§177.2600 for "Rubber articles intended for repeated use"

④ Buffer specification

J	Rotating
K	Non-rotating

⑤ Buffer stroke

Stroke [mm]	Pad diameter
	All sizes
3	●
6	●

With adapter

⑥ Connection thread/ ⑦ Vacuum inlet

○: ZP3-T/Vertical ●: ZP3-Y/Lateral

⑥ Connection thread			⑦ Vacuum inlet		Pad diameter	
Type	Symbol	Size	Type	Symbol	Size	All sizes
Male thread	A3	M3 x 0.5	—	Nil	—*1	○
			Female thread	B3	M3 x 0.5	○
	A6	M6 x 0.75	One-touch fitting	02	$\varnothing 2$	○
			Barb fitting	04	$\varnothing 4$	○
				U2	For $\varnothing 2$ polyurethane tubing*2	○
		U4	For $\varnothing 4$ soft tubing*3	○		
Female thread	B3	M3 x 0.5	—	Nil	—*1	○
			Female thread	B3	M3 x 0.5	●
			One-touch fitting	02	$\varnothing 2$	●
			Barb fitting	04	$\varnothing 4$	●
				U2	For $\varnothing 2$ polyurethane tubing	●
	U4	For $\varnothing 4$ soft tubing	●			

*1 Use the connection thread.

*2 Polyurethane tube piping

*3 Soft nylon/Polyurethane tube piping

With buffer

⑦ Vacuum inlet

○: ZP3-T/Vertical ●: ZP3-Y/Lateral

Type	Symbol	Size	Pad diameter
			All sizes
Female thread	B3	M3 x 0.5	○●
One-touch fitting	02	$\varnothing 2$	○●
	04	$\varnothing 4$	○●
Barb fitting	U2	For $\varnothing 2$ polyurethane tubing	○●
	U4	For $\varnothing 4$ soft tubing	○●

* It is not necessary to select a connection thread.

* The pad, mounting nut, and fitting are shipped together but do not come assembled.

Dimensions/Models

Single unit $\varnothing 1.5$ to $\varnothing 3.5$

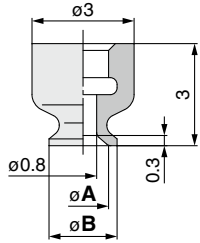

Construction	p. 160
Mounting Bracket Assembly	From p. 162

ZP3 - 015 U N
① ②

Model	①		②	A	B
	Pad dia.	Form			
ZP3	015	U	N S U F GN GS	1.5	2
	02			2	2.5
	035			3.5	4

*1 N: NBR, S: Silicone rubber, U: Urethane rubber, F: FKM, GN: Conductive NBR, GS: Conductive silicone rubber

With adapter $\varnothing 1.5$ to $\varnothing 3.5$

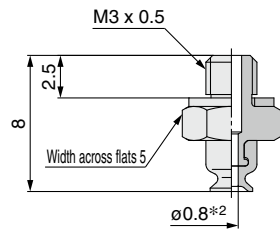

Construction	p. 160
Adapter Assembly	p. 162

ZP3 - T 015 U N - A3
① ② ③

③ Connection thread
(Male thread)

A3	M3 x 0.5
----	----------

Model	Vacuum inlet direction	①		②	③
		Pad dia.	Form		
ZP3	T	015	U	N S U F GN GS	A3
		02			
		035			

*1 N: NBR, S: Silicone rubber, U: Urethane rubber, F: FKM, GN: Conductive NBR, GS: Conductive silicone rubber

*2 Indicates the minimum hole size of the adapter or vacuum pad

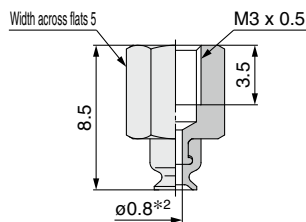

Construction	p. 160
Adapter Assembly	p. 162

ZP3 - T 015 U N - B3
① ② ③

③ Connection thread
(Female thread)

B3	M3 x 0.5
----	----------

Model	Vacuum inlet direction	①		②	③
		Pad dia.	Form		
ZP3	T	015	U	N S U F GN GS	B3
		02			
		035			

*1 N: NBR, S: Silicone rubber, U: Urethane rubber, F: FKM, GN: Conductive NBR, GS: Conductive silicone rubber

*2 Indicates the minimum hole size of the adapter or vacuum pad

Dimensions/Models

With adapter $\varnothing 1.5$ to $\varnothing 3.5$

ZP3 - T 015 U N - A6 - B3

① ②

Connection thread (Male thread)
A6 M6 x 0.75

④ Vacuum inlet

B3	M3 x 0.5	Female thread
02	$\varnothing 2$	One-touch fitting
04	$\varnothing 4$	One-touch fitting
U2	For $\varnothing 2$ polyurethane tubing	Barb fitting
U4	For $\varnothing 4$ soft tubing	

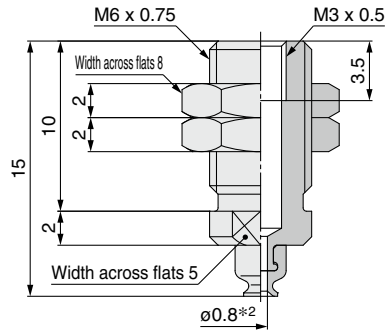

Vacuum inlet: One-touch fitting

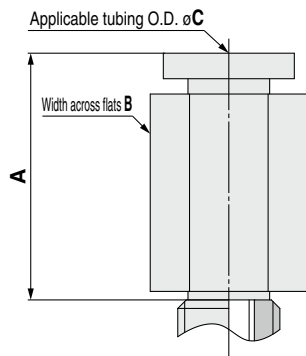

Vacuum inlet: Barb fitting

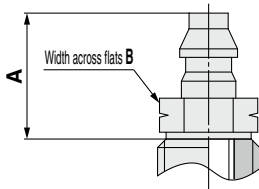

Construction	p. 160
Adapter Assembly	p. 163

Model		①	②	③	④
Vacuum inlet direction	Pad dia.	Form	Material*	Connection thread	Vacuum inlet
ZP3	T	015 02 035	U N S U F G N S	A6	B3

Dimensions Per Vacuum Inlet: One-touch Fitting

Model		①	②	③	④	A	B	C	Fitting part min. hole size	Fitting part no.
Vacuum inlet direction	Pad dia.	Form	Material*	Connection thread	Vacuum inlet					
ZP3	T	015 02 035	U N S U F G N S	A6	02	13	5.5	2	$\varnothing 1.2$	KQ2H02-M3G
					04	14.5	8	4		KQ2H04-M3G

Dimensions Per Vacuum Inlet: Barb Fitting

Model		①	②	③	④	A	B	Fitting part min. hole size	Fitting part no.
Vacuum inlet direction	Pad dia.	Form	Material*	Connection thread	Vacuum inlet				
ZP3	T	015 02 035	U N S U F G N S	A6	U2	6.5	4.5	$\varnothing 0.9$	M-3AU-2
					U4	7.4	5	$\varnothing 1.2$	M-3AU-4-X83

*1 N: NBR, S: Silicone rubber, U: Urethane rubber, F: FKM, GN: Conductive NBR, GS: Conductive silicone rubber

*2 Indicates the minimum hole size of the adapter or vacuum pad

Dimensions/Models

With adapter $\varnothing 1.5$ to $\varnothing 3.5$

ZP3 - Y **015** **U** **N** - **B3** - **B3**

①

②

③

④

Vacuum inlet

Connection thread (Female thread)
B3 M3 x 0.5

B3	M3 x 0.5	Female thread
02	$\varnothing 2$	One-touch fitting
04	$\varnothing 4$	One-touch fitting
U2	For $\varnothing 2$ polyurethane tubing	Barb fitting
U4	For $\varnothing 4$ soft tubing	

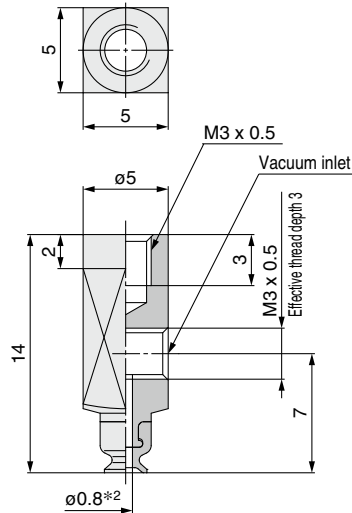

Model					
Vacuum inlet direction	① Pad dia.	Form	② Material*1	③ Connection thread	④ Vacuum inlet
ZP3	Y	015 02 035	U	N S U F GN GS	B3 B3

Dimensions Per Vacuum Inlet: One-touch Fitting

Model						A	B	C	Fitting part min. hole size	Fitting part no.
Vacuum inlet direction	① Pad dia.	Form	② Material*1	③ Connection thread	④ Vacuum inlet					
ZP3	Y	015 02 035	U	N S U F GN GS	B3	02	13	5.5	$\varnothing 1.2$	KQ2H02-M3G
							04	14.5		8

Vacuum inlet: One-touch fitting

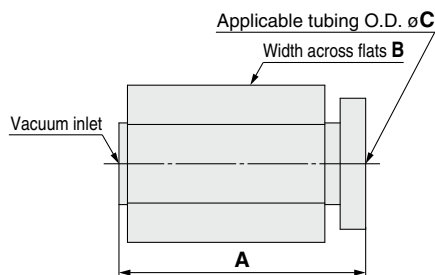

Vacuum inlet: Barb fitting

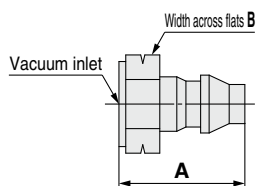

Dimensions Per Vacuum Inlet: Barb Fitting

Model						A	B	Fitting part min. hole size	Fitting part no.	
Vacuum inlet direction	① Pad dia.	Form	② Material*1	③ Connection thread	④ Vacuum inlet					
ZP3	Y	015 02 035	U	N S U F GN GS	B3	U2	6.5	4.5	$\varnothing 0.9$	M-3AU-2
						U4	7.4	5	$\varnothing 1.2$	M-3AU-4-X83

*1 N: NBR, S: Silicone rubber, U: Urethane rubber, F: FKM, GN: Conductive NBR, GS: Conductive silicone rubber

*2 Indicates the minimum hole size of the adapter or vacuum pad

Construction	p. 160
Adapter Assembly	p. 162

Dimensions/Models

With buffer $\varnothing 1.5$ to $\varnothing 3.5$

ZP3 - T 015 U N J 3 - B3

① ② ③ ④ ⑤

⑤ Vacuum inlet

Buffer specification ③

J	Rotating
K	Non-rotating

B3	M3 x 0.5	Female thread
02	$\varnothing 2$	One-touch fitting
04	$\varnothing 4$	One-touch fitting
U2	For $\varnothing 2$ polyurethane tubing	Barb fitting
U4	For $\varnothing 4$ soft tubing	

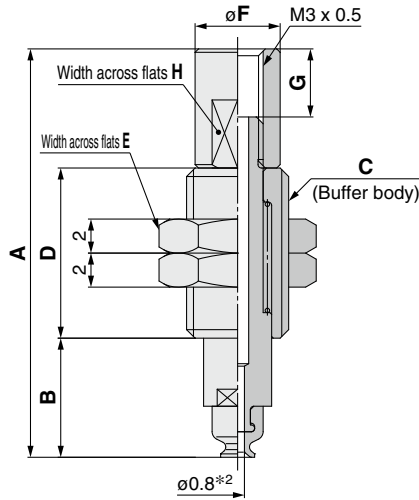

		Model					A	B	C	D	E	F	G	H	
Vacuum inlet direction	① Pad dia.	Form	② ^{*1} Material	③ Buffer spec.	④ Buffer stroke	⑤ Vacuum inlet									
ZP3	T	015 02 035	U	N S U F GN GS	J	3	B3	24	7	M6 x 0.75	10	8	5	4	4
						6		31	10		14				
					K	3	M8 x 0.75	11	10	7	3	6			
						6		26.5					8	14.5	
							33	11							

Dimensions Per Vacuum Inlet: One-touch Fitting

		Model					J	K	L	Fitting part min. hole size	Fitting part no.	
Vacuum inlet direction	① Pad dia.	Form	② ^{*1} Material	③ Buffer spec.	④ Buffer stroke	⑤ Vacuum inlet						
ZP3	T	015 02 035	U	N S U F GN GS	J K	3 6	02	13	5.5	2	$\varnothing 1.2$	KQ2H02-M3G
								14.5	8	4		KQ2H04-M3G

Vacuum inlet: One-touch fitting

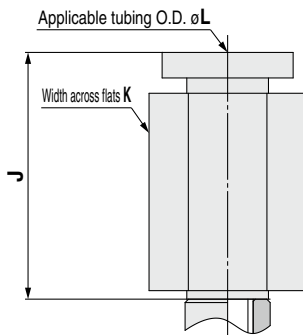

Dimensions Per Vacuum Inlet: Barb Fitting

		Model					J	K	Fitting part min. hole size	Fitting part no.	
Vacuum inlet direction	① Pad dia.	Form	② ^{*1} Material	③ Buffer spec.	④ Buffer stroke	⑤ Vacuum inlet					
ZP3	T	015 02 035	U	N S U F GN GS	J K	3 6	U2	6.5	4.5	$\varnothing 0.9$	M-3AU-2
							U4	7.4	5	$\varnothing 1.2$	M-3AU-4-X83

Vacuum inlet: Barb fitting

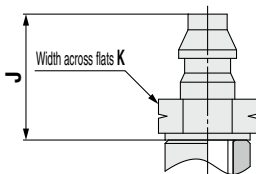

*1 N: NBR, S: Silicone rubber, U: Urethane rubber, F: FKM, GN: Conductive NBR, GS: Conductive silicone rubber

*2 Indicates the minimum hole size of the adapter or vacuum pad

Construction	p. 161
Buffer Assembly	p. 164

Dimensions/Models

With buffer $\varnothing 1.5$ to $\varnothing 3.5$

ZP3 - Y **015** **U** **N** **J** **3** - **B3**

① ② ③ ④

⑤ Vacuum inlet

Buffer specification ③

J	Rotating
K	Non-rotating

B3	M3 x 0.5	Female thread
02	$\varnothing 2$	One-touch fitting
04	$\varnothing 4$	One-touch fitting
U2	For $\varnothing 2$ polyurethane tubing	Barb fitting
U4	For $\varnothing 4$ soft tubing	

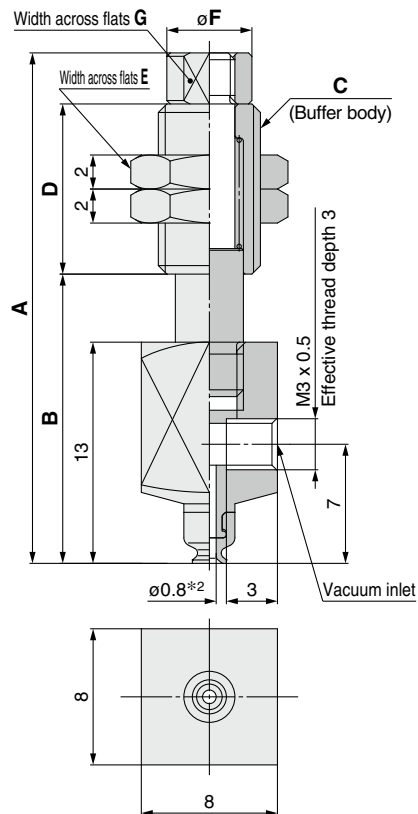

		Model					A	B	C	D	E	F	G	
	Vacuum inlet direction	① Pad dia.	Form	② ^{*1} Material	③ Buffer spec.	④ Buffer stroke	⑤ Vacuum inlet							
ZP3	Y	015 02 035	U	N S U F GN GS	J	3	B3	30	17	M6 x 0.75	10	8	5	4
						6		37	20		14			
					K	3	34	17	M8 x 0.75	11	10	7	6	
						6	40.5	20		14.5				

Dimensions Per Vacuum Inlet: One-touch Fitting

		Model					H	J	K	Fitting part min. hole size	Fitting part no.	
	Vacuum inlet direction	① Pad dia.	Form	② ^{*1} Material	③ Buffer spec.	④ Buffer stroke	⑤ Vacuum inlet					
ZP3	Y	015 02 035	U	N S U F GN GS	J K	3 6	02	13	5.5	2	$\varnothing 1.2$	KQ2H02-M3G
							04	14.5	8	4		KQ2H04-M3G

Dimensions Per Vacuum Inlet: Barb Fitting

		Model					H	J	Fitting part min. hole size	Fitting part no.	
	Vacuum inlet direction	① Pad dia.	Form	② ^{*1} Material	③ Buffer spec.	④ Buffer stroke	⑤ Vacuum inlet				
ZP3	Y	015 02 035	U	N S U F GN GS	J K	3 6	U2	6.5	4.5	$\varnothing 0.9$	M-3AU-2
							U4	7.4	5	$\varnothing 1.2$	M-3AU-4-X83

*1 N: NBR, S: Silicone rubber, U: Urethane rubber, F: FKM, GN: Conductive NBR, GS: Conductive silicone rubber

*2 Indicates the minimum hole size of the adapter or vacuum pad

Vacuum inlet: One-touch fitting

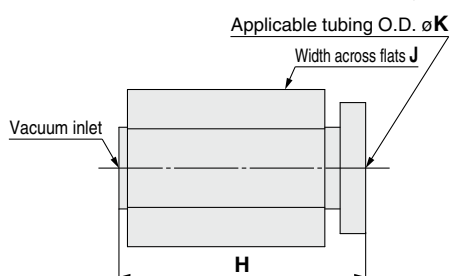

Vacuum inlet: Barb fitting

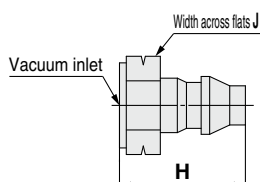

Construction	p. 161
Buffer Assembly	p. 164



Compact Type Flat Type with Groove

ZP3 Series

Pad diameter: $\varnothing 4, \varnothing 6, \varnothing 8, \varnothing 10, \varnothing 13, \varnothing 16$



Model Selection

How to Order

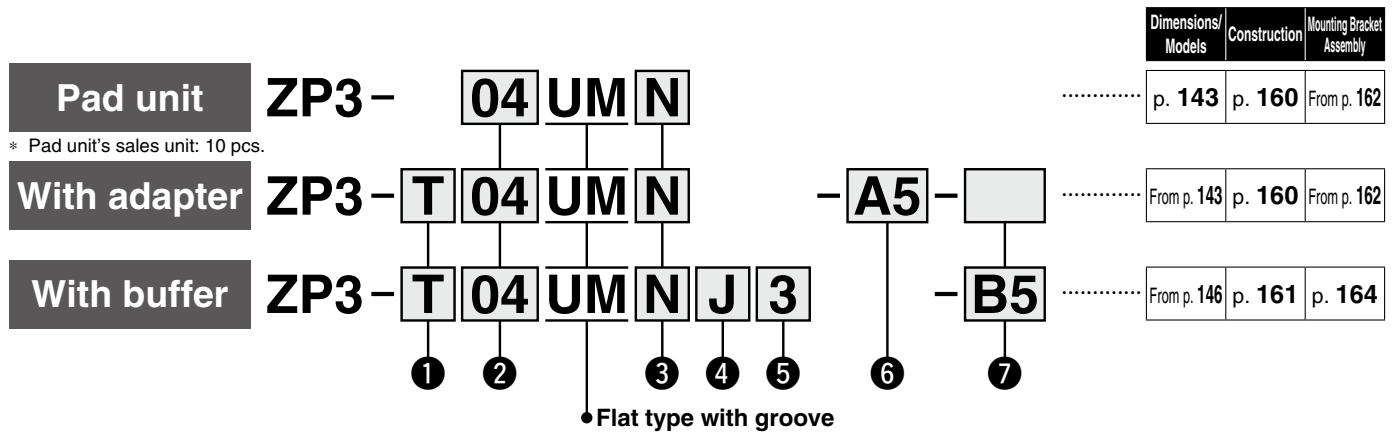

① Vacuum inlet direction

Nil	Pad unit
T	Vertical
Y	Lateral

② Pad diameter

04	$\varnothing 4$
06	$\varnothing 6$
08	$\varnothing 8$
10	$\varnothing 10$
13	$\varnothing 13$
16	$\varnothing 16$

③ Material

N	NBR
S	Silicone rubber*1
U	Urethane rubber
F	FKM
GN	Conductive NBR
GS	Conductive silicone rubber

*1 Compliant with the FDA (USA Food and Drug Administration) regulation 21CFR§177.2600 for "Rubber articles intended for repeated use"

④ Buffer specification

J	Rotating
JB	Rotating, With bushing
K	Non-rotating

⑤ Buffer stroke

Stroke [mm]	Buffer specification		
	J	JB	K
3	●	—	●
6	●	—	●
10	●	—	●
15	—	●	●
20	—	●	●

With adapter

⑥ Connection thread/⑦ Vacuum inlet ○: ZP3-T/Vertical ●: ZP3-Y/Lateral

Type	⑥ Connection thread		⑦ Vacuum inlet		Pad diameter [mm]			
	Symbol	Size	Type	Symbol	Size	$\varnothing 4$ to $\varnothing 8$ $\varnothing 10$ to $\varnothing 16$		
Male thread	A5	M5 x 0.8	—	Nil	Use the connection thread.	○ ○ ○		
			A10	M10 x 1	Female thread	B5	M5 x 0.8	○ —
					One-touch fitting	02	$\varnothing 2$	○ —
					Barb fitting	U2	For $\varnothing 2$ polyurethane tubing*1	○ —
						U4	For $\varnothing 4$ soft tubing*2	○ —
			A12	M12 x 1	Female thread	B5	M5 x 0.8	— ○
	One-touch fitting	02			$\varnothing 2$	— ○		
		04			$\varnothing 4$	— ○		
		06			$\varnothing 6$	— ○		
	Barb fitting	U2			For $\varnothing 2$ polyurethane tubing*1	— ○		
		U4			For $\varnothing 4$ soft tubing*2	— ○		
		U6	For $\varnothing 6$ soft tubing*2	— ○				
Female thread	B5	M5 x 0.8	—	Nil	Use the connection thread.	○ ○		
			Female thread	B5	M5 x 0.8	● ●		
			One-touch fitting	02	$\varnothing 2$	● ●		
				04	$\varnothing 4$	● ●		
				06	$\varnothing 6$	— ●		
			Barb fitting	U2	For $\varnothing 2$ polyurethane tubing*1	● ●		
				U4	For $\varnothing 4$ soft tubing*2	● ●		
				U6	For $\varnothing 6$ soft tubing*2	— ●		

With buffer

⑦ Vacuum inlet ○: ZP3-T/Vertical ●: ZP3-Y/Lateral

Type	Symbol	Size	Pad diameter [mm]	
			$\varnothing 4$ to $\varnothing 8$	$\varnothing 10$ to $\varnothing 16$
Female thread	B5	M5 x 0.8	○ ●	○ ●
One-touch fitting	02	$\varnothing 2$	○ ●	○ ●
	04	$\varnothing 4$	○ ●	○ ●
	06	$\varnothing 6$	—	○ ●
Barb fitting	U2	For $\varnothing 2$ polyurethane tubing*1	○ ●	○ ●
	U4	For $\varnothing 4$ soft tubing*2	○ ●	○ ●
	U6	For $\varnothing 6$ soft tubing*2	—	○ ●

*1 Polyurethane tube piping

*2 Soft nylon/Polyurethane tube piping

* It is not necessary to select a connection thread.

* The pad, mounting nut, and fitting are shipped together but do not come assembled.

ZP3 Compact

Flat Type

Flat Type with Groove

Bellows Type

Bellows Type with Ribs

Construction

Mounting Bracket Assembly

Precautions

Dimensions/Models

Single unit $\phi 4$ to $\phi 16$

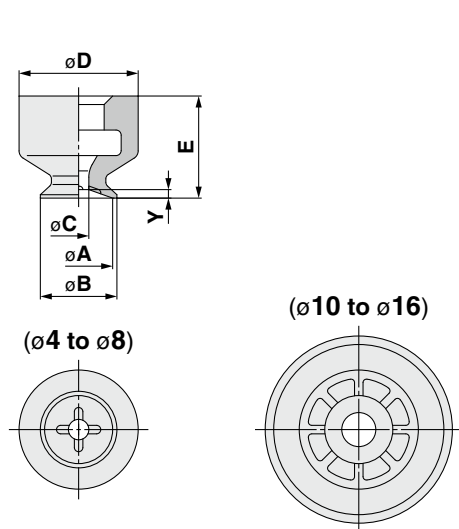

ZP3 - **04** UM **N**

① ②

Model	① Pad dia.	② Form	② ^{*1} Material	A	B	C	D	E	Y
	06		S	6	6.5	2	9	7	1
	08		U	8	8.5				
	10		F	10	11				
	13		GN	13	14	17			1.2
	16		GS	16	17				

*1 N: NBR, S: Silicone rubber, U: Urethane rubber, F: FKM, GN: Conductive NBR, GS: Conductive silicone rubber

Construction	p. 160
Mounting Bracket Assembly	From p. 162

With adapter $\phi 4$ to $\phi 16$

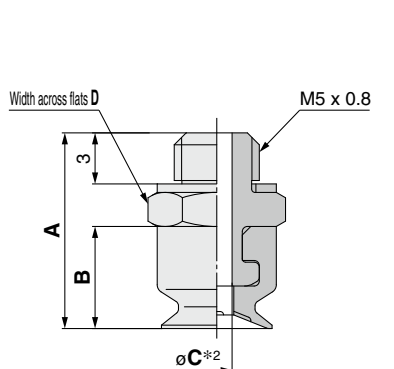

ZP3 - T **04** UM **N** - **A5**

① ② ③

③ Connection thread
(Male thread)

A5	M5 x 0.8
-----------	----------

Model	Vacuum inlet direction	① Pad dia.	② Form	② ^{*1} Material	③ Connection thread	A	B	C* ²	D
		06		S					
		08		U		12.5	7	1.8	10
		10		F					
		13		GN					
		16		GS					

*1 N: NBR, S: Silicone rubber, U: Urethane rubber, F: FKM, GN: Conductive NBR, GS: Conductive silicone rubber

*2 Indicates the minimum hole size of the adapter or vacuum pad

Construction	p. 160
Adapter Assembly	p. 162

With adapter $\phi 4$ to $\phi 16$

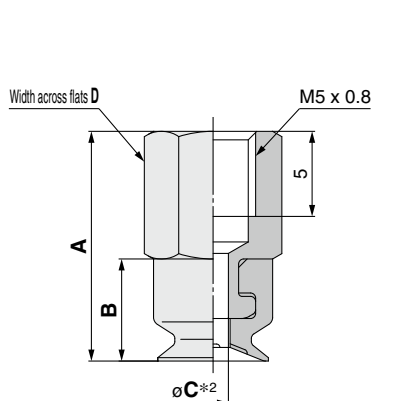

ZP3 - T **04** UM **N** - **B5**

① ② ③

③ Connection thread
(Female thread)

B5	M5 x 0.8
-----------	----------

Model	Vacuum inlet direction	① Pad dia.	② Form	② ^{*1} Material	③ Connection thread	A	B	C* ²	D
		06		S					
		08		U		14.5	7	1.8	10
		10		F					
		13		GN					
		16		GS					

*1 N: NBR, S: Silicone rubber, U: Urethane rubber, F: FKM, GN: Conductive NBR, GS: Conductive silicone rubber

*2 Indicates the minimum hole size of the adapter or vacuum pad

Construction	p. 160
Adapter Assembly	p. 162

Dimensions/Models

With adapter $\phi 4$ to $\phi 16$

Pad diameter: $\phi 4$ to $\phi 6$

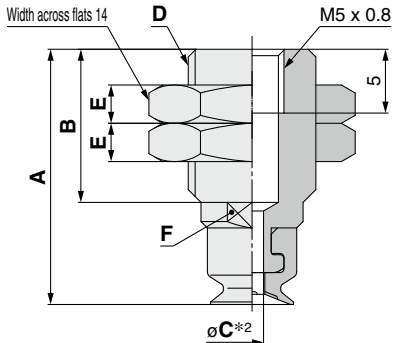

Pad diameter: $\phi 10$ to $\phi 16$

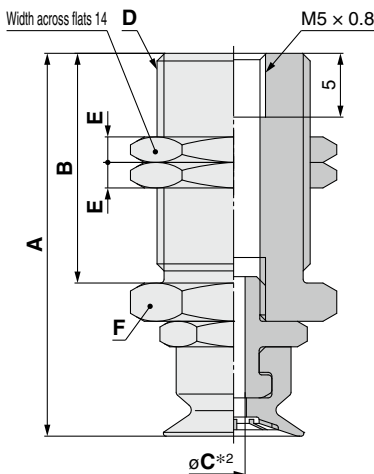

Vacuum inlet: One-touch fitting ($\phi 2$)

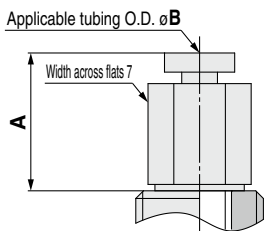

Vacuum inlet: Built-in One-touch fitting ($\phi 4, \phi 6$)

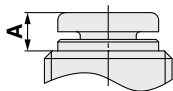

Vacuum inlet: Barb fitting

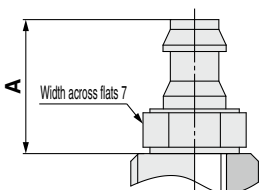

ZP3 - T 04 UM N - A10 - B5

① Pad dia. ② Material ③ Connection thread (Male thread) ④ Vacuum inlet

A10	M10 x 1
A12	M12 x 1

B5	M5 x 0.8	Female thread
02	$\phi 2$	One-touch fitting
04	$\phi 4$	
06	$\phi 6$	
U2	For $\phi 2$ polyurethane tubing	Barb fitting
U4	For $\phi 4$ soft tubing	
U6	For $\phi 6$ soft tubing	

		Model				A	B	C*2	D	E	F	
	Vacuum inlet direction	① Pad dia.	Form	②*1 Material	③ Connection thread							④ Vacuum inlet
ZP3	T	04	UM	N S U F GN GS	A10	B5	20	12	1.2	M10 x 1	3	Width across flats 7
		06 08										
		10 13 16			A12	30	18	1.8	M12 x 1	2	Width across flats 14	

Dimensions Per Vacuum Inlet: One-touch Fitting

		Model				A	B	Fitting part min. hole size	Fitting part no.	
	Vacuum inlet direction	① Pad dia.	Form	②*1 Material	③ Connection thread					④ Vacuum inlet
ZP3	T	04 06 08	UM	N S U F GN GS	A10	02	10.8	2	$\phi 1.4$	KQ2H02-M5N
						04	3	4	$\phi 1.8$	
		10 13 16			A12	02	10.8	2	$\phi 1.4$	KQ2H02-M5N
						04	3	4	$\phi 1.8$	
					06		3.2	6	$\phi 1.8$	

Dimensions Per Vacuum Inlet: Barb Fitting

		Model				A	Fitting part min. hole size	Fitting part no.	
	Vacuum inlet direction	① Pad dia.	Form	②*1 Material	③ Connection thread				④ Vacuum inlet
ZP3	T	04 06 08	UM	N S U F GN GS	A10	U2	6.5	$\phi 0.9$	M-5AU-2
						U4	8.5	$\phi 1.8$	M-5AU-4
		10 13 16			A12	U2	6.5	$\phi 0.9$	M-5AU-2
						U4	8.5	$\phi 1.8$	M-5AU-4
					U6		10.5	$\phi 2.5$	M-5AU-6

*1 N: NBR, S: Silicone rubber, U: Urethane rubber, F: FKM, GN: Conductive NBR, GS: Conductive silicone rubber

*2 Indicates the minimum hole size of the adapter or vacuum pad

Construction	p. 160
Adapter Assembly	p. 163

Dimensions/Models

With adapter $\varnothing 4$ to $\varnothing 16$

ZP3 - Y **04** UM **N** - **B5** - **B5**

①

②

③

④ Vacuum inlet

Connection thread
(Female thread)

B5	M5 x 0.8
-----------	----------

B5	M5 x 0.8	Female thread
02	$\varnothing 2$	One-touch fitting
04	$\varnothing 4$	
06	$\varnothing 6$	
U2	For $\varnothing 2$ polyurethane tubing	Barb fitting
U4	For $\varnothing 4$ soft tubing	
U6	For $\varnothing 6$ soft tubing	

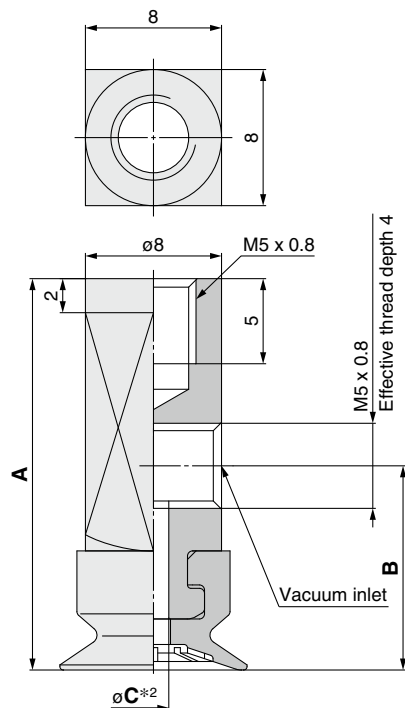

Vacuum inlet: One-touch fitting

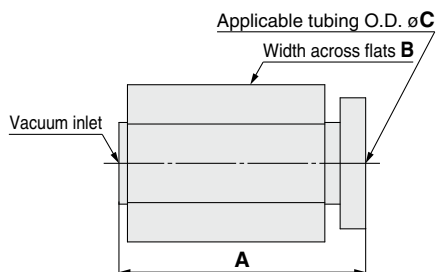

Vacuum inlet: Barb fitting

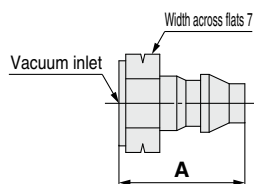

Construction	p. 160
Adapter Assembly	p. 162

		Model					A	B	C*2
Vacuum inlet direction	① Pad dia.	Form	②*1 Material	③ Connection thread	④ Vacuum inlet				
ZP3	Y	04	UM	N S U F GN GS	B5	B5	22	11	1.2
		06							2
		08					23	12	2
		10							
13									
16									

Dimensions Per Vacuum Inlet: One-touch Fitting

		Model					A	B	C	Fitting part min. hole size	Fitting part no.
Vacuum inlet direction	① Pad dia.	Form	②*1 Material	③ Connection thread	④ Vacuum inlet						
ZP3	Y	04 06 08 10 13 16	UM	N S U F GN GS	B3	02	10.8	7	2	$\varnothing 1.4$	KQ2H02-M5N
						04	14.7	8	4	$\varnothing 2.5$	KQ2H04-M5N
						02	10.8	7	2	$\varnothing 1.4$	KQ2H02-M5N
						04	14.7	8	4	$\varnothing 2.5$	KQ2H04-M5N
						06		10	6	$\varnothing 2.5$	KQ2H06-M5N

Dimensions Per Vacuum Inlet: Barb Fitting

		Model					A	Fitting part min. hole size	Fitting part no.
Vacuum inlet direction	① Pad dia.	Form	②*1 Material	③ Connection thread	④ Vacuum inlet				
ZP3	Y	04 06 08 10 13 16	UM	N S U F GN GS	B5	U2	6.5	$\varnothing 0.9$	M-5AU-2
						U4	8.5	$\varnothing 1.8$	M-5AU-4
						U2	6.5	$\varnothing 0.9$	M-5AU-2
						U4	8.5	$\varnothing 1.8$	M-5AU-4
						U6	10.5	$\varnothing 2.5$	M-5AU-6

*1 N: NBR, S: Silicone rubber, U: Urethane rubber, F: FKM, GN: Conductive NBR, GS: Conductive silicone rubber

*2 Indicates the minimum hole size of the adapter or vacuum pad

Dimensions/Models

With buffer $\varnothing 4$ to $\varnothing 16$

ZP3 - T **04** **UM** **N** **J** **3** - **B5**

① ② ③ ④ ⑤

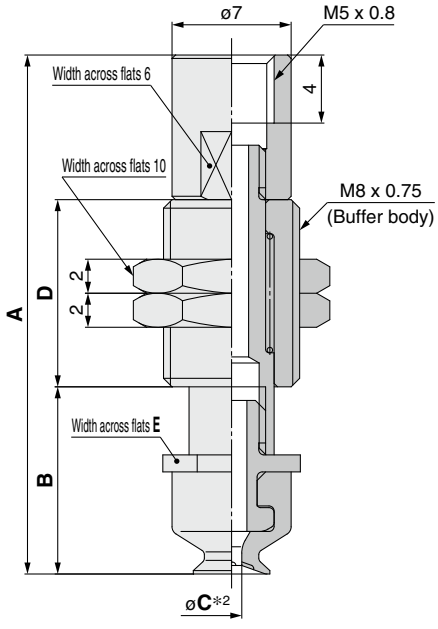

Buffer specification ③

J	Rotating
JB	Rotating, With bushing
K	Non-rotating

⑤ Vacuum inlet

B5	M5 x 0.8	Female thread
02	$\varnothing 2$	One-touch fitting
04	$\varnothing 4$	
06	$\varnothing 6$	
U2	For $\varnothing 2$ polyurethane tubing	Barb fitting
U4	For $\varnothing 4$ soft tubing	
U6	For $\varnothing 6$ soft tubing	

Vacuum inlet: One-touch fitting

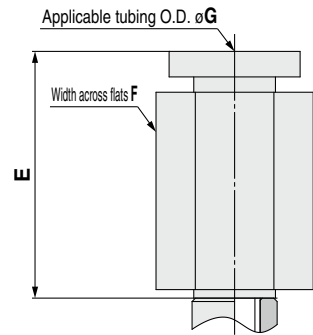

Vacuum inlet: Barb fitting

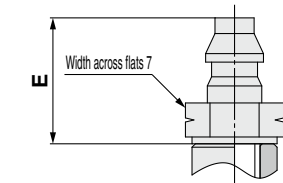

Construction	p. 161
Buffer Assembly	p. 164

		Model					A	B	C*2	D	E	
Vacuum inlet direction	① Pad dia.	② Form	③ Material	④ Buffer spec.	⑤ Buffer stroke							
ZP3	T	04	UM	N S U F GN GS	J K	3	30.5	11	1.2	11	7	
						6	37	14		14.5		
						10	47	18		20.5		
						3	30.5	11	11			
						6	37	14	14.5			
						10	47	18	20.5			
	T	04	UM	N S U F GN GS	JB K	B5	15	55	36.5	1.2	10	
							20	62.5	44			20.5
							15	55	36.5			14.5
							20	62.5	44	20.5		
							3	31.5	12	11		
							6	38	15	14.5		
T	10	13	16	J K	J K	3	48	19	1.8	20.5	10	
						6	56	37.5		10		
						10	63.5	45		10		
						15	56	37.5	10			
						20	63.5	45	10			
						15	56	37.5	10			
20	63.5	45	10									

Dimensions Per Vacuum Inlet: One-touch Fitting

		Model					E	F	G	Fitting part min. hole size	Fitting part no.
Vacuum inlet direction	① Pad dia.	② Form	③ Material	④ Buffer spec.	⑤ Buffer stroke						
ZP3	T	04	UM	N S U F GN GS	J JB K	3	10.8	7	2	$\varnothing 1.4$	KQ2H02-M5N
						6	14.7	8	4	$\varnothing 2.5$	KQ2H04-M5N
						10	10.8	7	2	$\varnothing 1.4$	KQ2H02-M5N
						15	14.7	8	4	$\varnothing 2.5$	KQ2H04-M5N
						20	14.7	8	4	$\varnothing 2.5$	KQ2H04-M5N
						20	14.7	10	6	$\varnothing 2.5$	KQ2H06-M5N

Dimensions Per Vacuum Inlet: Barb Fitting

		Model					E	Fitting part min. hole size	Fitting part no.
Vacuum inlet direction	① Pad dia.	② Form	③ Material	④ Buffer spec.	⑤ Buffer stroke				
ZP3	T	04	UM	N S U F GN GS	J JB K	3	6.5	$\varnothing 0.9$	M-5AU-2
						6	8.5	$\varnothing 1.8$	M-5AU-4
						10	6.5	$\varnothing 0.9$	M-5AU-2
						15	8.5	$\varnothing 1.8$	M-5AU-4
						20	8.5	$\varnothing 1.8$	M-5AU-4
						20	10.5	$\varnothing 2.5$	M-5AU-6

*1 N: NBR, S: Silicone rubber, U: Urethane rubber, F: FKM, GN: Conductive NBR, GS: Conductive silicone rubber

*2 Indicates the minimum hole size of the adapter or vacuum pad

Dimensions/Models

With buffer $\varnothing 4$ to $\varnothing 16$

ZP3 - Y **04** **UM** **N** **J** **3** - **B5**

①

②

④

⑤ Vacuum inlet

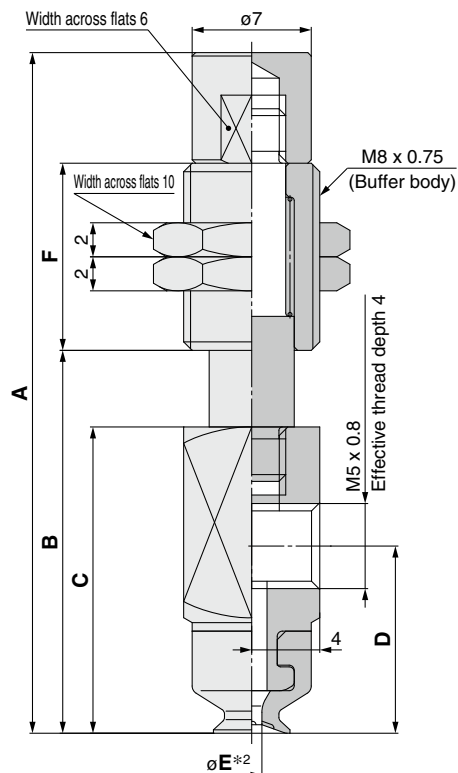

Buffer specification ③

J	Rotating
JB	Rotating, With bushing
K	Non-rotating

B5	M5 x 0.8	Female thread
02	$\varnothing 2$	One-touch fitting
04	$\varnothing 4$	
06	$\varnothing 6$	
U2	For $\varnothing 2$ polyurethane tubing	Barb fitting
U4	For $\varnothing 4$ soft tubing	
U6	For $\varnothing 6$ soft tubing	

Model	Vacuum inlet direction	① Pad dia.	Form	② Material	③ Buffer spec.	④ Buffer stroke	⑤ Vacuum inlet	A	B	C	D	E ^{#2}	F	
ZP3	Y	04	UM	N S U F GN GS	J K	3	B5	40	22.5	18	11	1.2	11	
						6		46	25				14.5	
		10			56	29		20.5						
		3			40	22.5		1.8	11					
		6			46	25			14.5					
		10			56	29		20.5						
	06 08	JB K	15	59	42.5	1.2	10							
			20	66.5	50									
	04	J K	10 13 16	UM	N S U F GN GS	JB K	3 6 10 15 20	B5	41	23.5	19	12	1.8	11
									6	47				26
	10 13 16	JB K	10 15 20	UM	N S U F GN GS	JB K	3 6 10 15 20	B5	57	30	19	12	1.8	20.5
									60	43.5				10
10 13 16	JB K	10 15 20	UM	N S U F GN GS	JB K	3 6 10 15 20	B5	67.5	57	19	12	1.8	10	

Dimensions Per Vacuum Inlet: One-touch Fitting

Model	Vacuum inlet direction	① Pad dia.	Form	② Material	③ Buffer spec.	④ Buffer stroke	⑤ Vacuum inlet	G	H	J	Fitting part min. hole size	Fitting part no.
ZP3	Y	04 06 08	UM	N S U F GN GS	J K	3	02	10.8	7	2	$\varnothing 1.4$	KQ2H02-M5N
						6		14.7	8	4	$\varnothing 2.5$	KQ2H04-M5N
		10 13 16			JB K	10 15 20	02	10.8	7	2	$\varnothing 1.4$	KQ2H02-M5N
								14.7	8	4	$\varnothing 2.5$	KQ2H04-M5N
		10 13 16			JB K	10 15 20	04 06	14.7	8	4	$\varnothing 2.5$	KQ2H04-M5N
								10	6	6	$\varnothing 2.5$	KQ2H06-M5N

Vacuum inlet: One-touch fitting

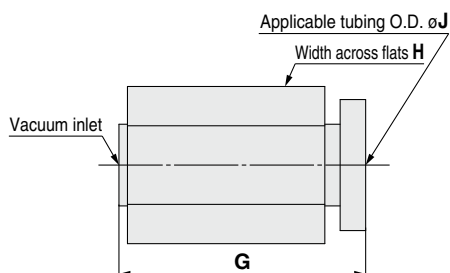

Vacuum inlet: Barb fitting

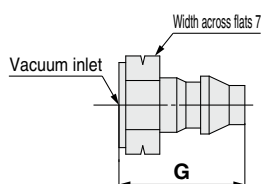

Dimensions Per Vacuum Inlet: Barb Fitting

Model	Vacuum inlet direction	① Pad dia.	Form	② Material	③ Buffer spec.	④ Buffer stroke	⑤ Vacuum inlet	G	Fitting part min. hole size	Fitting part no.
ZP3	Y	04 06 08	UM	N S U F GN GS	J K	3	U2	6.5	$\varnothing 0.9$	M-5AU-2
						6		8.5	$\varnothing 1.8$	M-5AU-4
		10 13 16			JB K	10 15 20	U2	6.5	$\varnothing 0.9$	M-5AU-2
								8.5	$\varnothing 1.8$	M-5AU-4
		10 13 16			JB K	10 15 20	U4 U6	10.5	$\varnothing 2.5$	M-5AU-6

*1 N: NBR, S: Silicone rubber, U: Urethane rubber, F: FKM, GN: Conductive NBR, GS: Conductive silicone rubber

*2 Indicates the minimum hole size of the adapter or vacuum pad

Construction	p. 161
Buffer Assembly	p. 164



Compact Type

Bellows Type

ZP3 Series

Pad diameter: $\varnothing 4$, $\varnothing 6$, $\varnothing 8$

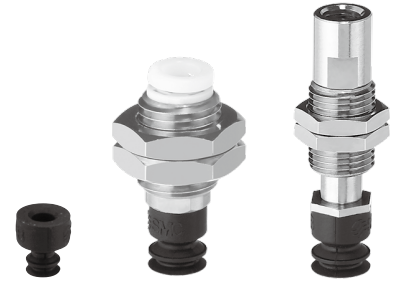

Model Selection

ZP3 Compact

Flat Type

Flat Type with Groove

Bellows Type

Bellows Type with Ribs

Construction

Mounting Bracket Assembly

Construction

Construction

Construction

Construction

Construction

Construction

Precautions

How to Order

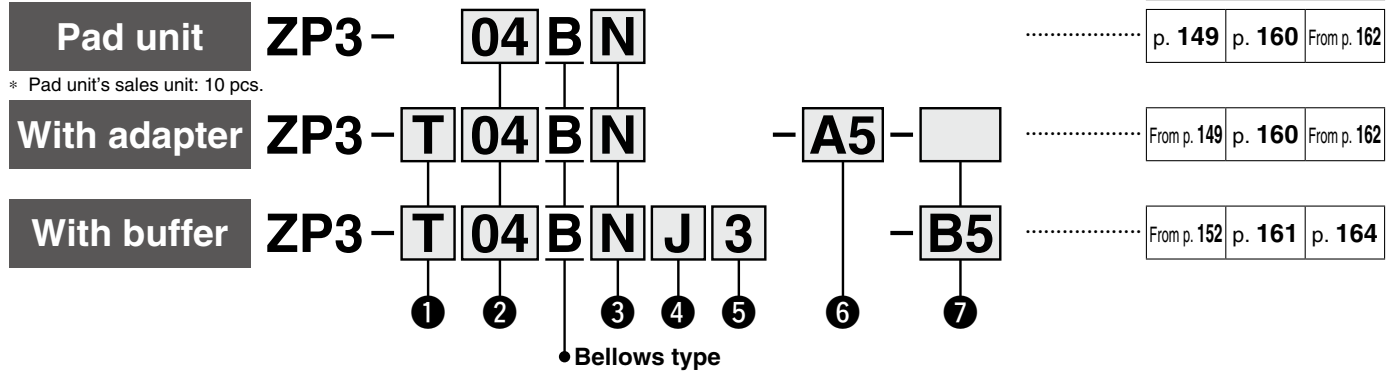

① Vacuum inlet direction

Nil	Pad unit
T	Vertical
Y	Lateral

② Pad diameter

04	$\varnothing 4$
06	$\varnothing 6$
08	$\varnothing 8$

③ Material

N	NBR
S	Silicone rubber*1
U	Urethane rubber
F	FKM
GN	Conductive NBR
GS	Conductive silicone rubber

④ Buffer specification

J	Rotating
JB	Rotating, With bushing
K	Non-rotating

⑤ Buffer stroke

Stroke [mm]	Buffer specification		
	J	JB	K
3	●	—	●
6	●	—	●
10	●	—	●
15	—	●	●
20	—	●	●

*1 Compliant with the FDA (USA Food and Drug Administration) regulation 21CFR§177.2600 for "Rubber articles intended for repeated use"

With adapter

⑥ Connection thread/ ⑦ Vacuum inlet

○: ZP3-T/Vertical ●: ZP3-Y/Lateral

⑥ Connection thread			⑦ Vacuum inlet			Pad diameter
Type	Symbol	Size	Type	Symbol	Size	All sizes
Male thread	A5	M5 x 0.8	—	Nil	Use the connection thread.	○
			Female thread	B5	M5 x 0.8	○
	A10	M10 x 1	One-touch fitting	02	$\varnothing 2$	○
			Barb fitting	04	$\varnothing 4$	○
				U2	For $\varnothing 2$ polyurethane tubing	○
Female thread	B5	M5 x 0.8	—	Nil	Use the connection thread.	○
			Female thread	B5	M5 x 0.8	●
	One-touch fitting	M5 x 0.8	One-touch fitting	02	$\varnothing 2$	●
			04	$\varnothing 4$	●	
			U2	For $\varnothing 2$ polyurethane tubing*1	●	
Barb fitting	M5 x 0.8	U4	For $\varnothing 4$ soft tubing*2	●		

*1 Polyurethane tube piping

*2 Soft nylon/Polyurethane tube piping

With buffer

⑦ Vacuum inlet

○: ZP3-T/Vertical ●: ZP3-Y/Lateral

Type	Symbol	Size	Pad diameter
			All sizes
Female thread	B5	M5 x 0.8	○●
One-touch fitting	02	$\varnothing 2$	○●
	04	$\varnothing 4$	○●
Barb fitting	U2	For $\varnothing 2$ polyurethane tubing*1	○●
	U4	For $\varnothing 4$ soft tubing*2	○●

* It is not necessary to select a connection thread.

* The pad, mounting nut, and fitting are shipped together but do not come assembled.

Dimensions/Models

Single unit $\varnothing 4$ to $\varnothing 8$

ZP3 - **04** **B** **N**
① ②

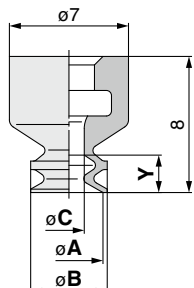

Construction	p. 160
Mounting Bracket Assembly	From p. 162

Model				A	B	C	Y
① Pad dia.	Form	② Material ^{*1}					
ZP3	04	B	N S U F GN GS	4	4.5	1.8	2.2
	06			6	7	2	3
	08			8	9		

*1 N: NBR, S: Silicone rubber, U: Urethane rubber, F: FKM, GN: Conductive NBR, GS: Conductive silicone rubber

With adapter $\varnothing 4$ to $\varnothing 8$

ZP3 - T **04** **B** **N** - **A5**
① ② ③

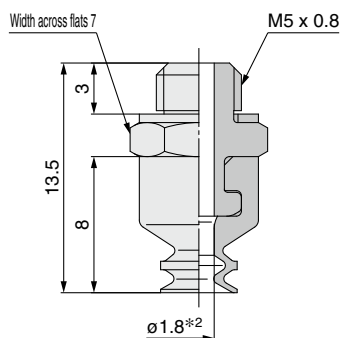

Construction	p. 160
Adapter Assembly	p. 162

③ Connection thread
(Male thread)

A5	M5 x 0.8
----	----------

Model					
	Vacuum inlet direction	① Pad dia.	Form	② Material ^{*1}	③ Connection thread
ZP3	T	04 06 08	B	N S U F GN GS	A5

*1 N: NBR, S: Silicone rubber, U: Urethane rubber, F: FKM, GN: Conductive NBR, GS: Conductive silicone rubber

*2 Indicates the minimum hole size of the adapter or vacuum pad

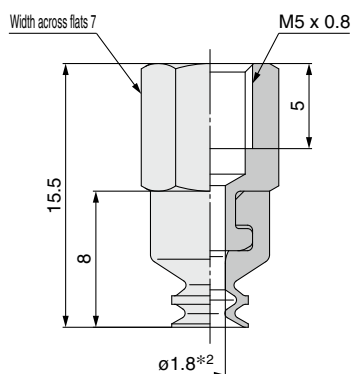

Construction	p. 160
Adapter Assembly	p. 162

ZP3 - T **04** **B** **N** - **B5**
① ② ③

③ Connection thread
(Female thread)

B5	M5 x 0.8
----	----------

Model					
	Vacuum inlet direction	① Pad dia.	Form	② Material ^{*1}	③ Connection thread
ZP3	T	04 06 08	B	N S U F GN GS	B5

*1 N: NBR, S: Silicone rubber, U: Urethane rubber, F: FKM, GN: Conductive NBR, GS: Conductive silicone rubber

*2 Indicates the minimum hole size of the adapter or vacuum pad

Dimensions/Models

With adapter ø4 to ø8

ZP3 - T 04 B N - A10 - B5

①

②

③

④

Connection thread (Female thread)

A10	M10 x 1
------------	---------

④ Vacuum inlet

B5	M5 x 0.8	Female thread
02	ø2	One-touch fitting
04	ø4	Barb fitting
U2	For ø2 polyurethane tubing	Barb fitting
U4	For ø4 soft tubing	

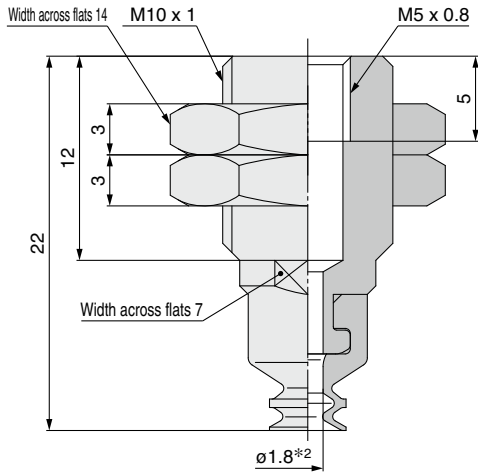

Model					
Vacuum inlet direction	① Pad dia.	Form	② Material*1	③ Connection thread	④ Vacuum inlet
ZP3	T	04 06 08	B	N S U F GN GS	A10 B5

Vacuum inlet: One-touch fitting (ø2)

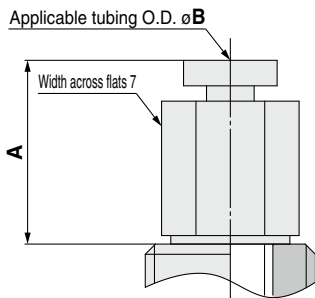

Dimensions Per Vacuum Inlet: One-touch Fitting

Model						A	B	Fitting part min. hole size	Fitting part no.
Vacuum inlet direction	① Pad dia.	Form	② Material*1	③ Connection thread	④ Vacuum inlet				
ZP3	T	04 06 08	B	N S U F GN GS	A10			ø1.4	KQ2H02-M5N
									02
					04	3	4	ø1.8	

Vacuum inlet: Built-in One-touch fitting (ø4)

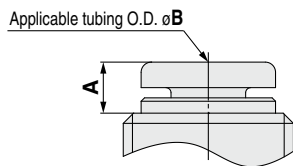

Dimensions Per Vacuum Inlet: Barb Fitting

Model						A	Fitting part min. hole size	Fitting part no.
Vacuum inlet direction	① Pad dia.	Form	② Material*1	③ Connection thread	④ Vacuum inlet			
ZP3	T	04 06 08	B	N S U F GN GS	A10			ø0.9
								U2
					U4	8.5	ø1.8	M-5AU-4

*1 N: NBR, S: Silicone rubber, U: Urethane rubber, F: FKM, GN: Conductive NBR, GS: Conductive silicone rubber

*2 Indicates the minimum hole size of the adapter or vacuum pad

Vacuum inlet: Barb fitting

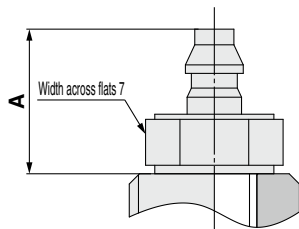

Construction	p. 160
Adapter Assembly	p. 163

Dimensions/Models

With adapter $\varnothing 4$ to $\varnothing 8$

ZP3 - Y **04** **B** **N** - **B5** - **B5**

① ②

③
Connection thread
(Female thread)

B5	M5 x 0.8
----	----------

④ Vacuum inlet

B5	M5 x 0.8	Female thread
02	$\varnothing 2$	One-touch fitting
04	$\varnothing 4$	Barb fitting
U2	For $\varnothing 2$ polyurethane tubing	Barb fitting
U4	For $\varnothing 4$ soft tubing	

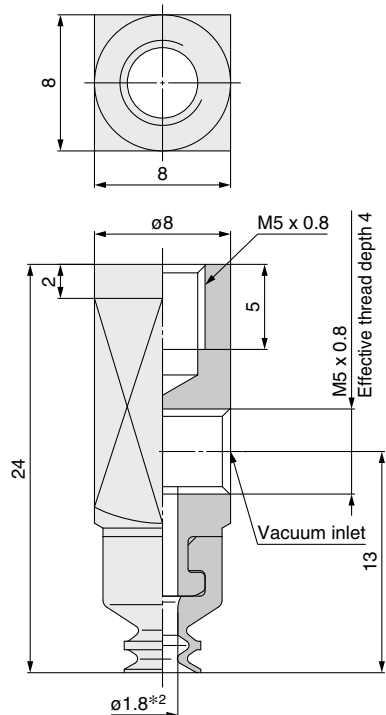

Model					
Vacuum inlet direction	① Pad dia.	Form	② Material*1	③ Connection thread	④ Vacuum inlet
ZP3	Y	04 06 08	B	N S U F GN GS	B5 B5

Dimensions Per Vacuum Inlet: One-touch Fitting

Model						A	B	C	Fitting part min. hole size	Fitting part no.	
Vacuum inlet direction	① Pad dia.	Form	② Material*1	③ Connection thread	④ Vacuum inlet						
ZP3	Y	04 06 08	B	N S U F GN GS	B5	02	10.8	7	2	$\varnothing 1.4$	KQ2H02-M5N
							14.7	8	4	$\varnothing 2.5$	KQ2H04-M5N

Vacuum inlet: One-touch fitting

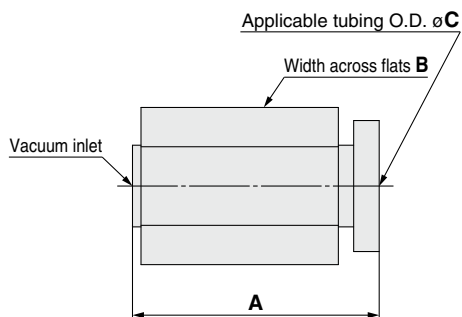

Dimensions Per Vacuum Inlet: Barb Fitting

Model						A	Fitting part min. hole size	Fitting part no.	
Vacuum inlet direction	① Pad dia.	Form	② Material*1	③ Connection thread	④ Vacuum inlet				
ZP3	Y	04 06 08	B	N S U F GN GS	B5	U2	6.5	$\varnothing 0.9$	M-5AU-2
						U4	8.5	$\varnothing 1.8$	M-5AU-4

*1 N: NBR, S: Silicone rubber, U: Urethane rubber, F: FKM, GN: Conductive NBR, GS: Conductive silicone rubber

*2 Indicates the minimum hole size of the adapter or vacuum pad

Vacuum inlet: Barb fitting

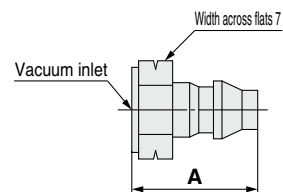

Construction	p. 160
Adapter Assembly	p. 162

Dimensions/Models

With buffer $\varnothing 4$ to $\varnothing 8$

ZP3 - T 04 B N J 3 - B5

① ② ③ ④ ⑤ Vacuum inlet

Buffer specification ③

J	Rotating
JB	Rotating, With bushing
K	Non-rotating

B5	M5 x 0.8	Female thread
02	$\varnothing 2$	One-touch fitting
04	$\varnothing 4$	Barb fitting
U2	For $\varnothing 2$ polyurethane tubing	
U4	For $\varnothing 4$ soft tubing	

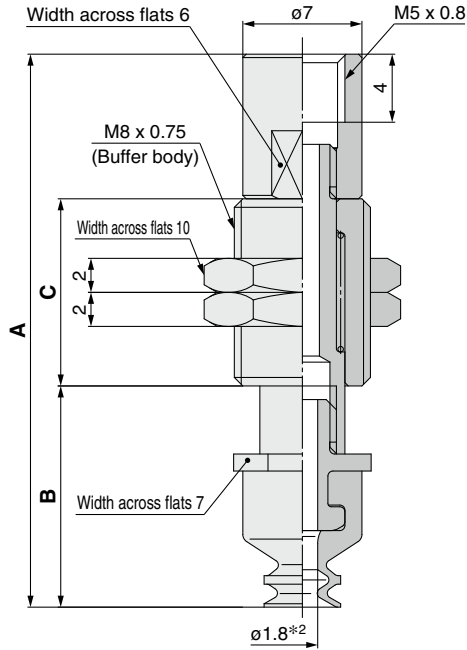

		Model					A	B	C	
Vacuum inlet direction	① Pad dia.	Form	② ^{*1} Material	③ Buffer spec.	④ Buffer stroke	⑤ Vacuum inlet				
ZP3	T	04 06 08	B	N S U F GN GS	J K	3	B5	32.5	13	11
						6		39	16	14.5
						10		49	20	20.5
					JB K	15		57	38.5	10
						20		64.5	46	

Vacuum inlet: One-touch fitting

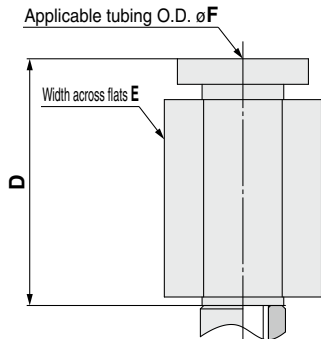

Dimensions Per Vacuum Inlet: One-touch Fitting

		Model					D	E	F	Fitting part min. hole size	Fitting part no.	
Vacuum inlet direction	① Pad dia.	Form	② ^{*1} Material	③ Buffer spec.	④ Buffer stroke	⑤ Vacuum inlet						
ZP3	T	04 06 08	B	N S U F GN GS	J K	3	02	10.8	7	2	$\varnothing 1.4$	KQ2H02-M5N
						6		14.7	8	4	$\varnothing 2.5$	KQ2H04-M5N
						10						
					JB K	15						
						20						

Vacuum inlet: Barb fitting

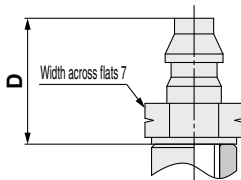

Dimensions Per Vacuum Inlet: Barb Fitting

		Model					D	Fitting part min. hole size	Fitting part no.	
Vacuum inlet direction	① Pad dia.	Form	② ^{*1} Material	③ Buffer spec.	④ Buffer stroke	⑤ Vacuum inlet				
ZP3	T	04 06 08	B	N S U F GN GS	J K	3	U2	6.5	$\varnothing 0.9$	M-5AU-2
						6				
						JB K		10	8.5	$\varnothing 1.8$
					15					
					20					

*1 N: NBR, S: Silicone rubber, U: Urethane rubber, F: FKM, GN: Conductive NBR, GS: Conductive silicone rubber

*2 Indicates the minimum hole size of the adapter or vacuum pad

Construction	p. 161
Buffer Assembly	p. 164

Dimensions/Models

With buffer $\phi 4$ to $\phi 8$

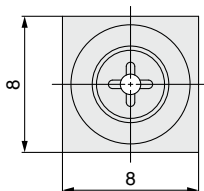
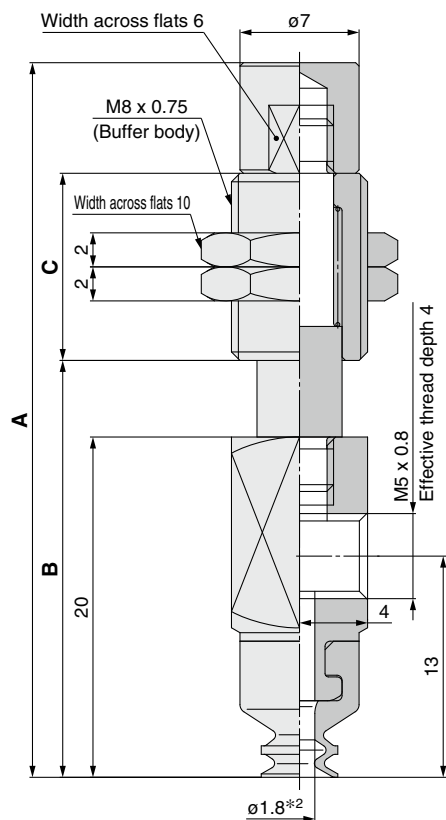

Vacuum inlet: One-touch fitting

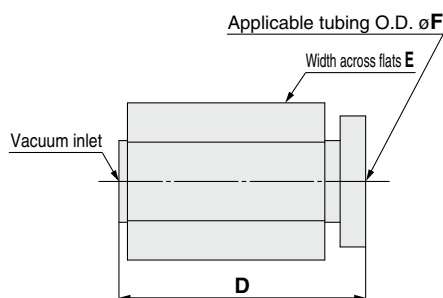

Vacuum inlet: Barb fitting

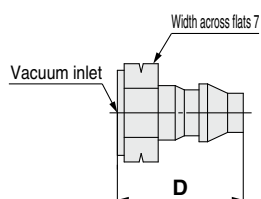

Construction	p. 161
Buffer Assembly	p. 164

ZP3 - Y **04** **B** **N** **J** **3** - **B5**

1	2	3	4	5 Vacuum inlet		
Buffer specification 3						
J	Rotating			B5	M5 x 0.8	Female thread
JB	Rotating, With bushing			02	$\phi 2$	One-touch fitting
K	Non-rotating			04	$\phi 4$	Barb fitting
				U2	For $\phi 2$ polyurethane tubing	
				U4	For $\phi 4$ soft tubing	

		Model					A	B	C	
Vacuum inlet direction	1 Pad dia.	Form	2 ^{*1} Material	3 Buffer spec.	4 Buffer stroke	5 Vacuum inlet				
ZP3	Y	04 06 08	B	N S U F GN GS	J K	3	B5	42	24.5	11
						6		48	27	14.5
						10		58	31	20.5
					JB K	15		61	44.5	10
						20		68.5	52	

Dimensions Per Vacuum Inlet: One-touch Fitting

		Model					D	E	F	Fitting part min. hole size	Fitting part no.	
Vacuum inlet direction	1 Pad dia.	Form	2 ^{*1} Material	3 Buffer spec.	4 Buffer stroke	5 Vacuum inlet						
ZP3	Y	04 06 08	B	N S U F GN GS	J K	3	02	10.8	7	2	$\phi 1.4$	KQ2H02-M5N
						6						
					JB K	10		14.7	8	4	$\phi 2.5$	KQ2H04-M5N
						15						
	20											

Dimensions Per Vacuum Inlet: Barb Fitting

		Model					D	Fitting part min. hole size	Fitting part no.	
Vacuum inlet direction	1 Pad dia.	Form	2 ^{*1} Material	3 Buffer spec.	4 Buffer stroke	5 Vacuum inlet				
ZP3	Y	04 06 08	B	N S U F GN GS	J K	3	U2	6.5	$\phi 0.9$	M-5AU-2
						6				
					JB K	10		8.5	$\phi 1.8$	M-5AU-4
						15				
	20									

*1 N: NBR, S: Silicone rubber, U: Urethane rubber, F: FKM, GN: Conductive NBR, GS: Conductive silicone rubber

*2 Indicates the minimum hole size of the adapter or vacuum pad



Compact Type

Bellows Type with Ribs

ZP3 Series

Pad diameter: $\varnothing 10, \varnothing 13, \varnothing 16$



Model Selection

ZP3 Compact

Flat Type

Flat Type with Groove

Bellows Type

Bellows Type with Ribs

Construction

Mounting Bracket Assembly

Precautions

How to Order

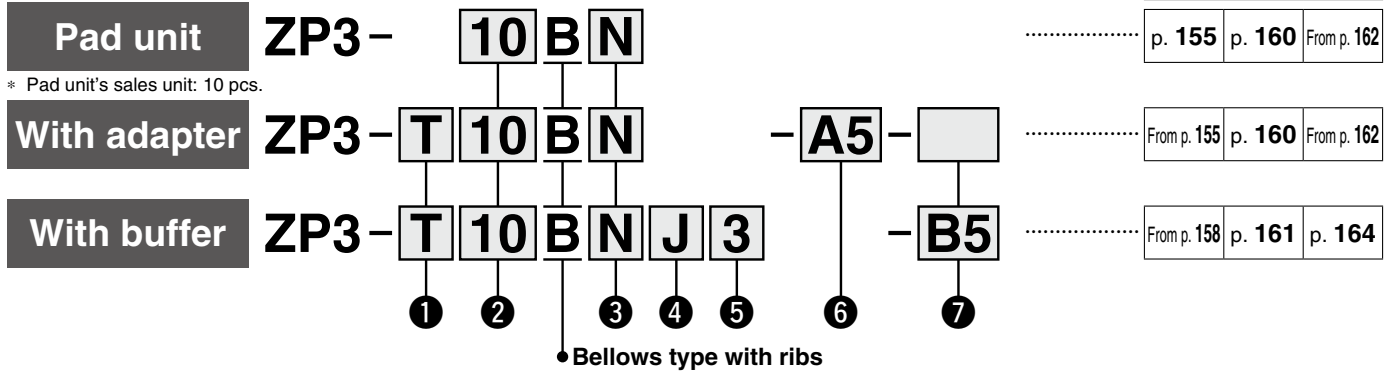

① Vacuum inlet direction

Nil	Pad unit
T	Vertical
Y	Lateral

② Pad diameter

10	$\varnothing 10$
13	$\varnothing 13$
16	$\varnothing 16$

③ Material

N	NBR
S	Silicone rubber*1
U	Urethane rubber
F	FKM
GN	Conductive NBR
GS	Conductive silicone rubber

*1 Compliant with the FDA (USA Food and Drug Administration) regulation 21CFR§177.2600 for "Rubber articles intended for repeated use"

④ Buffer specification

J	Rotating
JB	Rotating, With bushing
K	Non-rotating

⑤ Buffer stroke

Stroke [mm]	Buffer specification		
	J	JB	K
3	●	—	●
6	●	—	●
10	●	—	●
15	—	●	●
20	—	●	●

With adapter

⑥ Connection thread/⑦ Vacuum inlet ○: ZP3-T/Vertical ●: ZP3-Y/Lateral

⑥ Connection thread		⑦ Vacuum inlet		Pad diameter	
Type	Symbol	Type	Symbol	All sizes	
Male thread	A5	—	Nil	Use the connection thread. ○	
		Female thread	B5	M5 x 0.8 ○	
	One-touch fitting		02	$\varnothing 2$	○
			04	$\varnothing 4$	○
			06	$\varnothing 6$	○
	Barb fitting		U2	For $\varnothing 2$ polyurethane tubing	○
			U4	For $\varnothing 4$ soft tubing	○
		U6	For $\varnothing 6$ soft tubing	○	
Female thread	B5	—	Nil	Use the connection thread. ○	
		Female thread	B5	M5 x 0.8 ●	
	One-touch fitting		02	$\varnothing 2$	●
			04	$\varnothing 4$	●
			06	$\varnothing 6$	●
	Barb fitting		U2	For $\varnothing 2$ polyurethane tubing*1	●
			U4	For $\varnothing 4$ soft tubing*2	●
		U6	For $\varnothing 6$ soft tubing*2	●	

*1 Polyurethane tube piping
*2 Soft nylon/Polyurethane tube piping

With buffer

⑦ Vacuum inlet ○: ZP3-T/Vertical ●: ZP3-Y/Lateral

Type	Symbol	Size	Pad diameter
Female thread	B5	M5 x 0.8	○●
			All sizes
One-touch fitting	02	$\varnothing 2$	○●
	04	$\varnothing 4$	○●
	06	$\varnothing 6$	○●
Barb fitting	U2	For $\varnothing 2$ polyurethane tubing	○●
	U4	For $\varnothing 4$ soft tubing	○●
	U6	For $\varnothing 6$ soft tubing	○●

* It is not necessary to select a connection thread.

* The pad, mounting nut, and fitting are shipped together but do not come assembled.

Dimensions/Models

Single unit $\varnothing 10$ to $\varnothing 16$

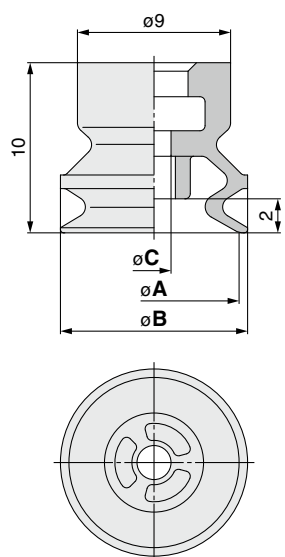

ZP3 - 10 B N
① ②

Model				A	B	C
①	②	③	④			
Pad dia.	Form	Material				
ZP3	10	B	N S U F GN GS	10	11	2
	13			13	14	3
	16			16	17	

*1 N: NBR, S: Silicone rubber, U: Urethane rubber, F: FKM, GN: Conductive NBR, GS: Conductive silicone rubber

Construction p. 160
Mounting Bracket Assembly From p. 162

With adapter $\varnothing 10$ to $\varnothing 16$

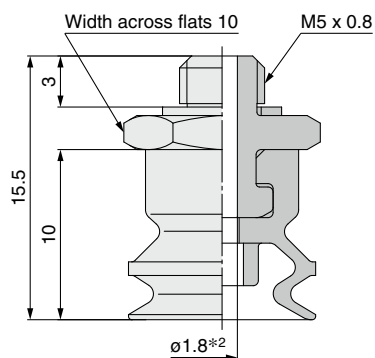

ZP3 - T 10 B N - A5
① ② ③

③ Connection thread (Male thread)

A5 M5 x 0.8

Model					
	Vacuum inlet direction	①	②	③	④
		Pad dia.	Form	Material	Connection thread
ZP3	T	10	B	N S U F GN GS	A5
		13			
		16			

*1 N: NBR, S: Silicone rubber, U: Urethane rubber, F: FKM, GN: Conductive NBR, GS: Conductive silicone rubber

*2 Indicates the minimum hole size of the adapter or vacuum pad

Construction p. 160
Adapter Assembly p. 162

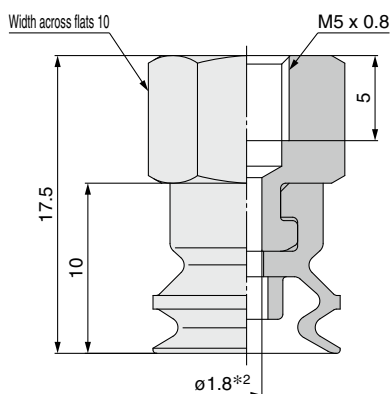

ZP3 - T 10 B N - B5
① ② ③

③ Connection thread (Female thread)

B5 M5 x 0.8

Model					
	Vacuum inlet direction	①	②	③	④
		Pad dia.	Form	Material	Connection thread
ZP3	T	10	B	N S U F GN GS	B5
		13			
		16			

*1 N: NBR, S: Silicone rubber, U: Urethane rubber, F: FKM, GN: Conductive NBR, GS: Conductive silicone rubber

*2 Indicates the minimum hole size of the adapter or vacuum pad

Construction p. 160
Adapter Assembly p. 162

Dimensions/Models

With adapter $\varnothing 10$ to $\varnothing 16$

ZP3 - T 10 B N - A12 - B5

① ②

Connection thread (Male thread)
A12 M12 x 1

④ Vacuum inlet

B5	M5 x 0.8	Female thread
02	$\varnothing 2$	One-touch fitting
04	$\varnothing 4$	
06	$\varnothing 6$	
U2	For $\varnothing 2$ polyurethane tubing	Barb fitting
U4	For $\varnothing 4$ soft tubing	
U6	For $\varnothing 6$ soft tubing	

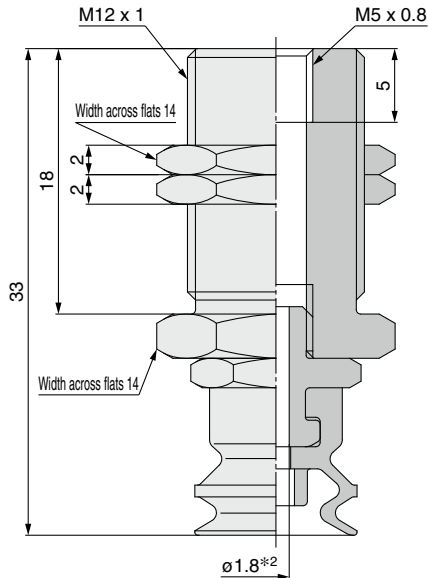

Model						
	Vacuum inlet direction	① Pad dia.	Form	②*1 Material	③ Connection thread	④ Vacuum inlet
ZP3	T	10 13 16	B	N S U F GN GS	A12	B5

Dimensions Per Vacuum Inlet: One-touch Fitting

Model						A	B	Fitting part min. hole size	Fitting part no.	
	Vacuum inlet direction	① Pad dia.	Form	②*1 Material	③ Connection thread					④ Vacuum inlet
ZP3	T	10 13 16	B	N S U F GN GS	A12	02	10.8	2	$\varnothing 1.4$	KQ2H02-M5N
						04	3	4	$\varnothing 1.8$	
						06	3.2	6		

Vacuum inlet: One-touch fitting

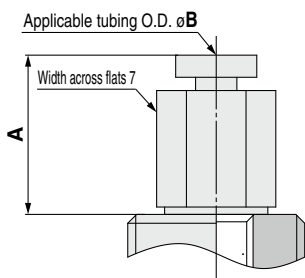

Vacuum inlet: Built-in One-touch fitting ($\varnothing 4, \varnothing 6$)

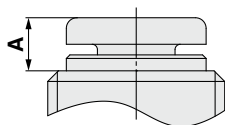

Vacuum inlet: Barb fitting

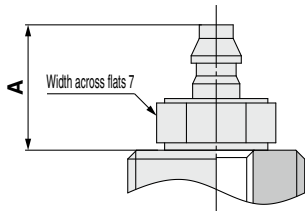

Dimensions Per Vacuum Inlet: Barb Fitting

Model						A	Fitting part min. hole size	Fitting part no.	
	Vacuum inlet direction	① Pad dia.	Form	②*1 Material	③ Connection thread				④ Vacuum inlet
ZP3	T	10 13 16	B	N S U F GN GS	A12	U2	6.5	$\varnothing 0.9$	M-5AU-2
						U4	8.5	$\varnothing 1.8$	M-5AU-4
						U6	10.5	$\varnothing 2.5$	M-5AU-6

*1 N: NBR, S: Silicone rubber, U: Urethane rubber, F: FKM, GN: Conductive NBR, GS: Conductive silicone rubber

*2 Indicates the minimum hole size of the adapter or vacuum pad

Construction	p. 160
Adapter Assembly	p. 163

Dimensions/Models

With adapter $\varnothing 10$ to $\varnothing 16$

ZP3 - Y **10** **B** **N** - **B5** - **B5**

①

②

③

④ Vacuum inlet

Connection thread
(Female thread)

B5	M5 x 0.8
----	----------

B5	M5 x 0.8	Female thread
02	$\varnothing 2$	One-touch fitting
04	$\varnothing 4$	
06	$\varnothing 6$	
U2	For $\varnothing 2$ polyurethane tubing	Barb fitting
U4	For $\varnothing 4$ soft tubing	
U6	For $\varnothing 6$ soft tubing	

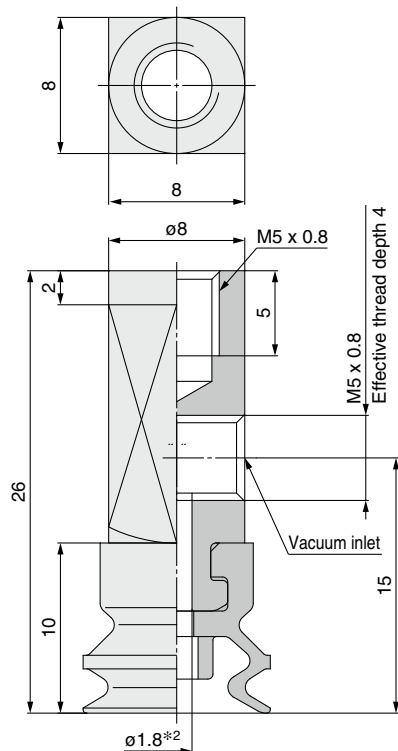

	Model					
	Vacuum inlet direction	① Pad dia.	Form	②*1 Material	③ Connection thread	④ Vacuum inlet
ZP3	Y	10 13 16	B	N S U F GN GS	B5	B5

Dimensions Per Vacuum Inlet: One-touch Fitting

	Model						A	B	C	Fitting part min. hole size	Fitting part no.
	Vacuum inlet direction	① Pad dia.	Form	②*1 Material	③ Connection thread	④ Vacuum inlet					
ZP3	Y	10 13 16	B	N S U F GN GS	B5	02	10.8	7	2	$\varnothing 1.4$	KQ2H02-M5N
						04	14.7	8	4	$\varnothing 2.5$	KQ2H04-M5N
						06					

Vacuum inlet: One-touch fitting

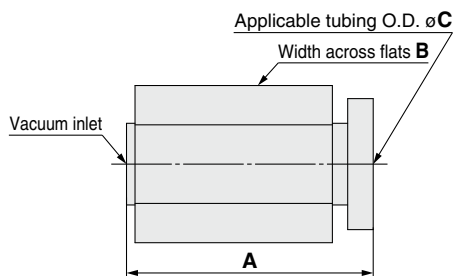

Dimensions Per Vacuum Inlet: Barb Fitting

	Model						A	Fitting part min. hole size	Fitting part no.
	Vacuum inlet direction	① Pad dia.	Form	②*1 Material	③ Connection thread	④ Vacuum inlet			
ZP3	Y	10 13 16	B	N S U F GN GS	B5	U2	6.5	$\varnothing 0.9$	M-5AU-2
						U4	8.5	$\varnothing 1.8$	M-5AU-4
						U6	10.5	$\varnothing 2.5$	M-5AU-6

Vacuum inlet: Barb fitting

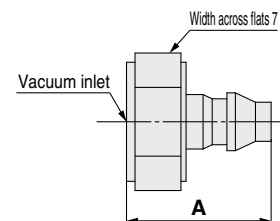

Construction	p. 160
Adapter Assembly	p. 162

*1 N: NBR, S: Silicone rubber, U: Urethane rubber, F: FKM, GN: Conductive NBR, GS: Conductive silicone rubber

*2 Indicates the minimum hole size of the adapter or vacuum pad

Dimensions/Models

With buffer $\varnothing 10$ to $\varnothing 16$

ZP3 - T 10 B N J 3 - B5

① ② ③ ④ ⑤

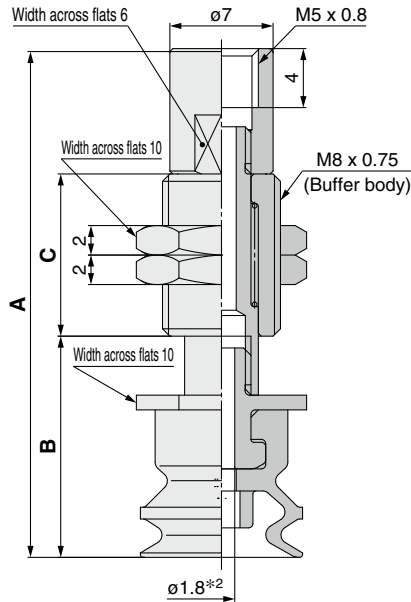

Buffer specification ③

J	Rotating
JB	Rotating, With bushing
K	Non-rotating

⑤ Vacuum inlet

B5	M5 x 0.8	Female thread
02	$\varnothing 2$	One-touch fitting
04	$\varnothing 4$	
06	$\varnothing 6$	
U2	For $\varnothing 2$ polyurethane tubing	Barb fitting
U4	For $\varnothing 4$ soft tubing	
U6	For $\varnothing 6$ soft tubing	

		Model					A	B	C	
	Vacuum inlet direction	① Pad dia.	Form	② ^{*1} Material	③ Buffer spec.	④ Buffer stroke				⑤ Vacuum inlet
ZP3	T	10 13 16	B	N S U F GN GS	J K	3	B5	34.5	15	11
						6		41	18	14.5
						10		51	22	20.5
						15		59	40.5	
						20		66.5	48	10

Dimensions Per Vacuum Inlet: One-touch Fitting

		Model					D	E	F	Fitting part min. hole size	Fitting part no.	
	Vacuum inlet direction	① Pad dia.	Form	② ^{*1} Material	③ Buffer spec.	④ Buffer stroke						⑤ Vacuum inlet
ZP3	T	10 13 16	B	N S U F GN GS	J JB K	3	02 04 06	10.8	7	2	$\varnothing 1.4$	KQ2H02-M5N
						6		14.7	8	4	$\varnothing 2.5$	KQ2H04-M5N
						10						
						15						
						20						

Vacuum inlet: One-touch fitting

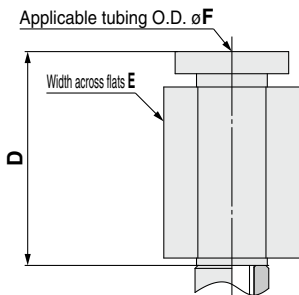

Vacuum inlet: Barb fitting

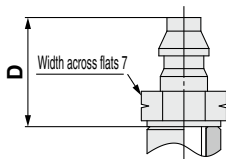

Dimensions Per Vacuum Inlet: Barb Fitting

		Model					D	Fitting part min. hole size	Fitting part no.	
	Vacuum inlet direction	① Pad dia.	Form	② ^{*1} Material	③ Buffer spec.	④ Buffer stroke				⑤ Vacuum inlet
ZP3	T	10 13 16	B	N S U F GN GS	J JB K	3	U2 U4 U6	6.5	$\varnothing 0.9$	M-5AU-2
						6		8.5	$\varnothing 1.8$	M-5AU-4
						10				
						15				
						20				

*1 N: NBR, S: Silicone rubber, U: Urethane rubber, F: FKM, GN: Conductive NBR, GS: Conductive silicone rubber

*2 Indicates the minimum hole size of the adapter or vacuum pad

Construction	p. 161
Buffer Assembly	p. 164

Dimensions/Models

With buffer $\varnothing 10$ to $\varnothing 16$

ZP3 - Y 10 B N J 3 - B5

① ② ③ ④ ⑤ Vacuum inlet

Buffer specification ③

J	Rotating
JB	Rotating, With bushing
K	Non-rotating

B5	M5 x 0.8	Female thread
02	$\varnothing 2$	One-touch fitting
04	$\varnothing 4$	
06	$\varnothing 6$	
U2	For $\varnothing 2$ polyurethane tubing	Barb fitting
U4	For $\varnothing 4$ soft tubing	
U6	For $\varnothing 6$ soft tubing	

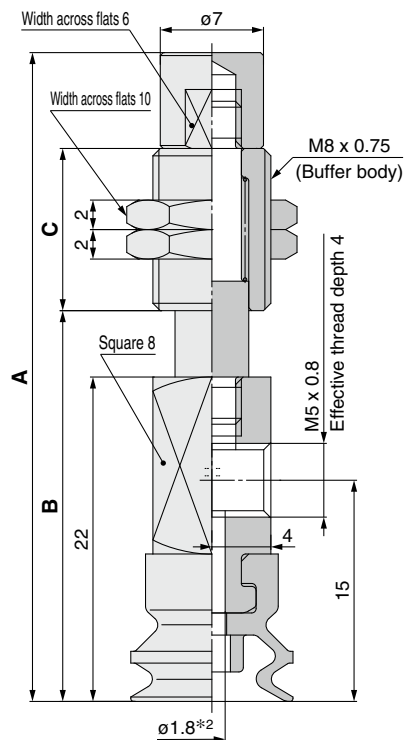

Vacuum inlet: One-touch fitting

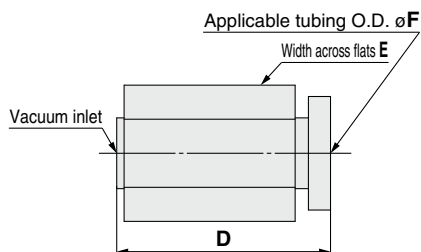

Vacuum inlet: Barb fitting

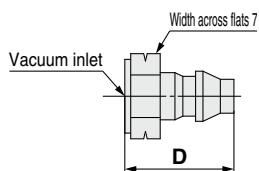

Construction	p. 161
Buffer Assembly	p. 164

		Model					A	B	C	
Vacuum inlet direction	① Pad dia.	Form	② ^{*1} Material	③ Buffer spec.	④ Buffer stroke	⑤ Vacuum inlet				
ZP3	Y	10 13 16	B	N S U F GN GS	J K JB K	3	B5	44	26.5	11
						6		50	29	14.5
						10		60	33	20.5
						15		63	46.5	10
						20		70.5	54	

Dimensions Per Vacuum Inlet: One-touch Fitting

		Model					D	E	F	Fitting part min. hole size	Fitting part no.	
Vacuum inlet direction	① Pad dia.	Form	② ^{*1} Material	③ Buffer spec.	④ Buffer stroke	⑤ Vacuum inlet						
ZP3	Y	10 13 16	B	N S U F GN GS	J JB K	3	14.7	10.8	7	2	$\varnothing 1.4$	KQ2H02-M5N
						6						8
						10		10	6	$\varnothing 2.5$	KQ2H06-M5N	
						15						
20												

Dimensions Per Vacuum Inlet: Barb Fitting

		Model					D	Fitting part min. hole size	Fitting part no.				
Vacuum inlet direction	① Pad dia.	Form	② ^{*1} Material	③ Buffer spec.	④ Buffer stroke	⑤ Vacuum inlet							
ZP3	Y	10 13 16	B	N S U F GN GS	J JB K	3	10.5	6.5	$\varnothing 0.9$	M-5AU-2			
						6					8.5	$\varnothing 1.8$	M-5AU-4
						10 15 20					10.5	$\varnothing 2.5$	M-5AU-6

*1 N: NBR, S: Silicone rubber, U: Urethane rubber, F: FKM, GN: Conductive NBR, GS: Conductive silicone rubber

*2 Indicates the minimum hole size of the adapter or vacuum pad

Compact Type *ZP3 Series* Construction

Model
Selection

With adapter

Flat type: $\varnothing 1.5$ to $\varnothing 3.5$

Flat type with groove: $\varnothing 4$ to $\varnothing 16$

Bellows type: $\varnothing 4$ to $\varnothing 8$

Bellows type with ribs: $\varnothing 10$ to $\varnothing 16$

Vacuum inlet direction **Vertical** T Type/ZP3-T

ZP3-T□-A□

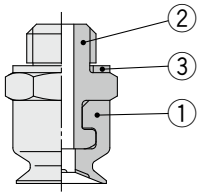

ZP3-T□-B□

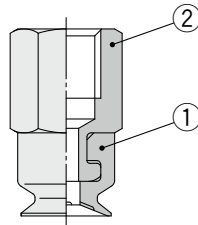

ZP3-T□-A□-B□

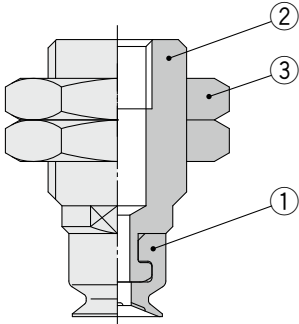

ZP3-T□-A□-(02/04/06)

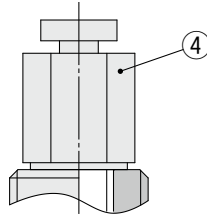

ZP3-T□-A□-(U2/U4/U6)

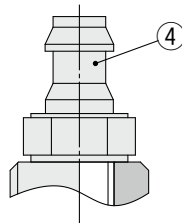

Component Parts

No.	Description	Material	Note
1	Pad	NBR, Silicone rubber, Urethane rubber, FKM, Conductive NBR, Conductive silicone rubber	Flat type Flat type with groove Bellows type Bellows type with ribs
2	Adapter	Brass (Electroless nickel plating)	
3	Gasket	Stainless steel/NBR	

Component Parts

No.	Description	Material	Note
1	Pad	NBR, Silicone rubber, Urethane rubber, FKM, Conductive NBR, Conductive silicone rubber	Flat type Flat type with groove Bellows type Bellows type with ribs
2	Adapter	Brass (Electroless nickel plating)	
3	Nut	Structural steel (Trivalent chromated)	M6 x 0.75 M12 x 1
4	Fitting	Steel (Zinc chromated)	M10 x 1

Vacuum inlet direction **Lateral** Y Type/ZP3-Y

ZP3-Y□-B□-B□

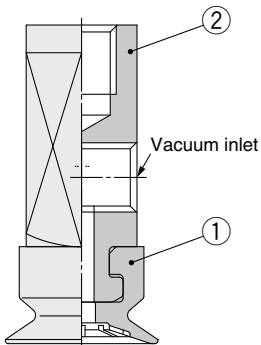

ZP3-Y□-B□-(02/04/06)

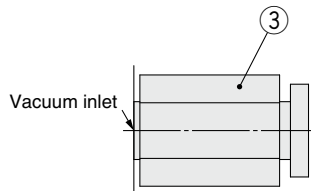

ZP3-Y□-B□-(U2/U4/U6)

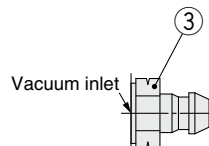

Component Parts

No.	Description	Material	Note
1	Pad	NBR, Silicone rubber, Urethane rubber, FKM, Conductive NBR, Conductive silicone rubber	Flat type Flat type with groove Bellows type Bellows type with ribs
2	Adapter	Brass (Electroless nickel plating)	
3	Fitting	—	

ZP3
Compact

Flat Type

Flat Type
with Groove

Bellows Type

Bellows Type
with Ribs

Construction

Mounting
Bracket
Assembly

Precautions

With buffer

Flat type: $\varnothing 1.5$ to $\varnothing 3.5$

Flat type with groove: $\varnothing 4$ to $\varnothing 16$

Bellows type: $\varnothing 4$ to $\varnothing 8$

Bellows type with ribs: $\varnothing 10$ to $\varnothing 16$

Vacuum inlet direction **Vertical** T Type/ZP3-T

ZP3-T□(J/K)□-B□

ZP3-T□JB□-B□

ZP3-T□K(15/20)□-B□

ZP3-T□-(02/04/06)

ZP3-T□-(U2/U4/U6)

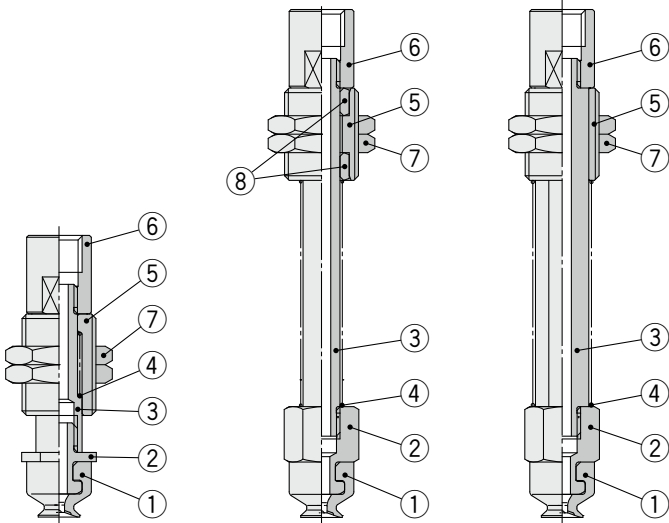

Component Parts

No.	Description	Material	Note
1	Pad	NBR, Silicone rubber, Urethane rubber, FKM, Conductive NBR, Conductive silicone rubber	Flat type Flat type with groove Bellows type Bellows type with ribs
2	Adapter	Brass (Electroless nickel plating)	
3	Piston rod	Stainless steel	
4	Return spring	Stainless steel	
5	Buffer body	Brass (Electroless nickel plating)	
6	Buffer adapter	Brass (Electroless nickel plating)	
7	Nut	Structural steel (Trivalent chromated)	M6 x 0.75 M8 x 0.75
8	Bushing	—	
9	Fitting	—	

Vacuum inlet direction **Lateral** Y Type/ZP3-Y

ZP3-Y□(J/K)□-B□

ZP3-Y□JP□-B□

ZP3-Y□K(15/20)□-B□

ZP3-Y□-(02/04/06)

ZP3-Y□-(U2/U4/U6)

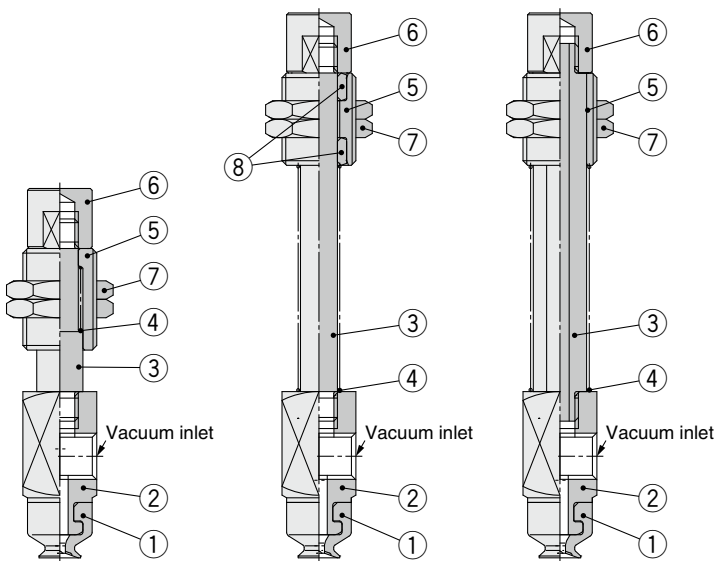

Component Parts

No.	Description	Material	Note
1	Pad	NBR, Silicone rubber, Urethane rubber, FKM, Conductive NBR, Conductive silicone rubber	Flat type Flat type with groove Bellows type Bellows type with ribs
2	Adapter	Brass (Electroless nickel plating)	
3	Piston rod	Stainless steel	
4	Return spring	Stainless steel	
5	Buffer body	Brass (Electroless nickel plating)	
6	Buffer adapter	Brass (Electroless nickel plating)	
7	Nut	Structural steel (Trivalent chromated)	M6 x 0.75 M8 x 0.75
8	Bushing	—	
9	Fitting	—	

Compact Type ZP3 Series Mounting Bracket Assembly

Model Selection

Adapter Assembly: Vacuum Inlet Direction **Vertical** T Type/ZP3-T

Product part no.	<p>ZP3 - T ① ② □ - ③</p> <p>Pad diameter ● Pad form ● Pad material ●</p> <p>● Connection thread (Male/Female thread)</p>	
Component parts	<p>Male thread</p> <p>② Gasket ① Adapter (With gasket)</p>	<p>Female thread</p> <p>① Adapter</p>

		Symbol	① Pad diameter symbol								
			015	02	035	04	06	08	10	13	16
② Pad form	Flat type	U	●	●	●	—	—	—	—	—	—
	Flat type with groove	UM	—	—	—	●	●	●	●	●	●
	Bellows type	B	—	—	—	●	●	●	●	●	●
③ Connection thread	Male thread	M3 x 0.5	ZP3A-T1-A3			—			—		
		M5 x 0.8	—			ZP3A-T2-A5			ZP3A-T3-A5		
	Female thread	M3 x 0.5	ZP3A-T1-B3			—			—		
		M5 x 0.8	—			ZP3A-T2-B5			ZP3A-T3-B5		
④ Gasket (Single unit)	10 pcs.*1		M-3G2			ZP-5G2			ZP-5G2		
	100 pcs.*1		—			M-5G2			M-5G2		

*1 The gasket (single unit) sales unit is shown.

Adapter Assembly: Vacuum Inlet Direction **Lateral** Y Type/ZP3-Y

Product part no.	<p>ZP3 - Y ① ② □ - ③ - ④</p> <p>Pad diameter ● Pad form ● Pad material ●</p> <p>● Vacuum inlet (Female thread)</p> <p>● Connection thread (Female thread)</p>	
Component parts	<p>① Adapter</p> <p>The One-touch fitting and barb fitting should be ordered separately. Refer to the dimensions for part numbers.</p>	

		Symbol	① Pad diameter symbol								
			015	02	035	04	06	08	10	13	16
② Pad form	Flat type	U	●	●	●	—	—	—	—	—	—
	Flat type with groove	UM	—	—	—	●	●	●	●	●	●
	Bellows type	B	—	—	—	●	●	●	●	●	●
③ Connection thread	Female thread	M3 x 0.5	B3	M3 x 0.5	B3	ZP3A-Y1-B3			—		
		M5 x 0.8	B5	M5 x 0.8	B5	—			ZP3A-Y2-B5		
	④ Vacuum inlet	Female thread	M3 x 0.5	B3	M3 x 0.5	B3	—			—	
M5 x 0.8			B5	M5 x 0.8	B5	—			ZP3A-Y3-B5		

ZP3 Compact

Flat Type

Flat Type with Groove

Bellows Type



Bellows Type with Ribs

Construction

Mounting Bracket Assembly

Precautions

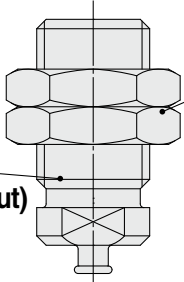
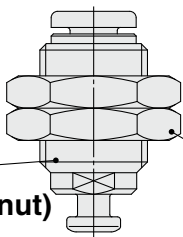
Adapter Assembly: Vacuum Inlet Direction Vertical T Type/ZP3-T

Product part no.	<p>ZP3 - T ① ② □ - ③ - ④</p> <p>● Pad diameter ● Pad form ● Vacuum inlet</p> <p>● Connection thread</p> <p>● Pad material</p>
Component parts	<div style="display: flex; justify-content: space-around; align-items: center;"> <div style="text-align: center;">  <p>Ⓐ Adapter (With mounting nut)</p> </div> <div style="text-align: center;">  <p>Ⓑ Adapter (With mounting nut)</p> </div> <div style="text-align: center;">  <p>Ⓒ Mounting nut</p> </div> <div style="text-align: center;">  <p>Ⓒ Mounting nut</p> </div> </div> <p style="font-size: small; margin-top: 10px;">The One-touch fitting and barb fitting for Ⓐ adapter should be ordered separately. Refer to the dimensions for part numbers.</p>

				Symbol	① Pad diameter symbol											
					015	02	035	04	06	08	10	13	16			
② Pad form				Flat type	U	●	●	●	—	—	—	—	—	—	—	
				Flat type with groove	UM	—	—	—	●	●	●	●	●	●	●	●
				Bellows type	B	—	—	—	●	●	●	●	●	●	●	●
Ⓐ Adapter	③ Connection thread	Male thread	M6 x 0.75	A6	④ Vacuum inlet	Female thread	M3 x 0.5	B3	ZP3A-T1-A6-B3			—				
			M10 x 1	A10			M5 x 0.8	B5	—			ZP3A-T2-A10-B5				
			M12 x 1	A12			M5 x 0.8	B5	—			ZP3A-T3-A12-B5				
Ⓑ Adapter	③ Connection thread	Male thread	M10 x 1	A10	④ Vacuum inlet	One-touch fitting	ø4	04	—			ZP3A-T2-A10-04				
			M12 x 1	A12			ø4	04	—			ZP3A-T3-A12-04				
							ø6	06	—			ZP3A-T3-A12-06				
Ⓒ Mounting nut (Single unit)				M6 x 0.75	ZPNA-M6A			—			—					
				M10 x 1	—			ZPNA-M10			—					
				M12 x 1	—			—			ZPNA-M12A					

Buffer Assembly: Vacuum Inlet Direction **Vertical** T Type/ZP3-T, **Lateral** Y Type/ZP3-Y

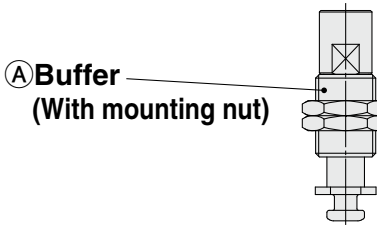
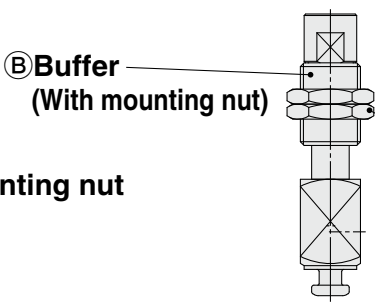
Product part no.	<p style="text-align: center;">ZP3 - (T/Y) ① ② □ - (J/JB/K) - ③ - ④</p> <p>T: Vertical vacuum inlet Y: Lateral vacuum inlet</p> <p>① Pad diameter ② Pad form □ Pad material ③ J: Rotating, JB: Rotating, With bushing, K: Non-rotating ④ Vacuum inlet (Female thread) Buffer stroke</p>	
Component parts	<p>Vertical vacuum inlet</p>  <p>① Buffer (With mounting nut) ③ Mounting nut</p>	<p>Lateral vacuum inlet</p>  <p>② Buffer (With mounting nut) ③ Mounting nut</p>

The One-touch fitting and barb fitting should be ordered separately. Refer to the dimensions for part numbers.

		Symbol	① Pad diameter symbol									
			015	02	035	04	06	08	10	13	16	
② Pad form	Flat type	U	●	●	●	—	—	—	—	—	—	
	Flat type with groove	UM	—	—	—	●	●	●	●	●	●	
	Bellows type	B	—	—	—	●	●	●	●	●	●	
Vertical	④ Vacuum inlet Female thread	B3	3	ZP3B-T1(J/K)3-B3			—			—		
			6	ZP3B-T1(J/K)6-B3			—			—		
			3	—			ZP3B-T2A(J/K)3-B5			ZP3B-T2B(J/K)3-B5		
		B5	6	—			ZP3B-T2A(J/K)6-B5			ZP3B-T2B(J/K)6-B5		
			10	—			ZP3B-T2A(J/K)10-B5			ZP3B-T2B(J/K)10-B5		
			15	—			ZP3B-T2A(JB/K)15-B5			ZP3B-T2B(JB/K)15-B5		
	B5	B3	3	ZP3B-Y1(J/K)3-B3			—			—		
			6	ZP3B-Y1(J/K)6-B3			—			—		
			3	—			ZP3B-Y2A(J/K)3-B5			ZP3B-Y2B(J/K)3-B5		
		B5	6	—			ZP3B-Y2A(J/K)6-B5			ZP3B-Y2B(J/K)6-B5		
			10	—			ZP3B-Y2A(J/K)10-B5			ZP3B-Y2B(J/K)10-B5		
			15	—			ZP3B-Y2A(JB/K)15-B5			ZP3B-Y2B(JB/K)15-B5		
B5	B3	20	—			ZP3B-T2A(JB/K)20-B5			ZP3B-T2B(JB/K)20-B5			
		20	—			ZP3B-Y2A(JB/K)20-B5			ZP3B-Y2B(JB/K)20-B5			
③ Mounting nut (Single unit)	M6 x 0.75		ZPNA-M6A			—			—			
	M8 x 0.75		—			ZPNA-M8A			ZPNA-M8A			

[Buffer part number example]

Product part no. **ZP3 - T 08UMN J 10 - 04**

Buffer **ZP3B - T 2A J 10 - B5**

③ Buffer stroke

One-touch fitting **KQ2H04-M5N**



Basic/Compact Type Specific Product Precautions

Be sure to read this before handling the products. Refer to page 375 for safety instructions. For vacuum equipment and vacuum pad precautions, refer to pages 376 to 379.

Mounting

1. Tighten the screw within the specified torque range when mounting the buffer.

Tightening with a torque outside of the specified range may cause malfunction.

Basic Type ZP Series

Model	Connection thread	Tightening torque [N·m]
ZP□(2 to 8)□(J/K)□-□-A8	M8 x 1	1.5 to 2.0
ZP□(10 to 32)□(J/K)□-□-A10	M10 x 1	2.5 to 3.5
ZP□(40/50)□(J/K)□-□-A12	M14 x 1	6.5 to 7.5

Compact Type ZP3 Series

Model	Connection thread	Tightening torque [N·m]
ZP3-□(015 to 035)□J□-□	M6 x 0.75	1.5 to 1.8
ZP3-□(015 to 035)□K□-□	M8 x 0.75	2.0 to 2.5
ZP3-□(04 to 16)□(J/JB/K)□-□		

How to Replace the Pad

1. How to replace the pad of the basic type ZP series

- 1 Pull the lock ring upward, and, after lifting it up to the adapter, remove the old pad by pulling it downward.
- 2 While holding the lock ring in the raised position, place a new pad onto the adapter.
- 3 Confirm that the pad is securely in place, and then return the lock ring to its original position.

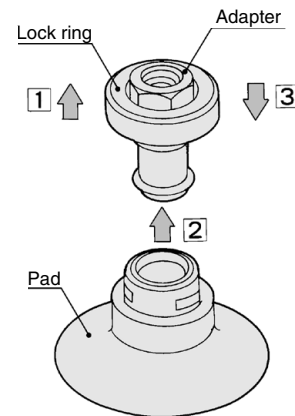

2. How to replace the pad of the basic (ball joint) type ZP series

Pad diameter: $\varnothing 10$ to $\varnothing 32$

- 1 Insert a hexagon wrench into the bottom of the pad, loosen the screw, and remove the old pad from the adapter.
- 2 Place a new pad on the adapter, and, after confirming that the O-ring is in place, retighten the screw with the hexagon wrench.

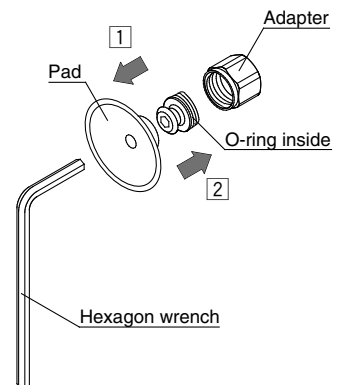

Pad diameter: $\varnothing 40$, $\varnothing 50$

- 1 Pull the lock ring upward, and, after lifting it up to the adapter, remove the old pad by pulling it downward.
- 2 While holding the lock ring in the raised position, place a new pad onto the adapter.
- 3 Confirm that the pad is securely in place, and then return the lock ring to its original position.

